

All vents are placed on both sides of the building

Recommended Specs

- 22 33 00 A1. Tank Less Water heater
- 22 13 01. Gray Water Tanks
- 22 13 00. Black Water Tanks
- 23 12 00. Fresh Water Tanks
- 23 40 00 E3. Toilet
- 22 33 00 A1 Kitchen Sink
- 22 11 00 Water Pump w/ Diaphragm pressure tank

Addition items can include: Water filter system, portable macerator pump.

Please verify all plumbing work complies with local building code for permanent installation.

① self-sustainable energy to water-waste management system  
1/2" = 1'-0"

# Angel Landings

www.angellandings.com

Tel# 917-653-0551

## Water and sewage waste management system - Cross Section thru the Kitchen Galley and water closet

# 22000

1/18/2020

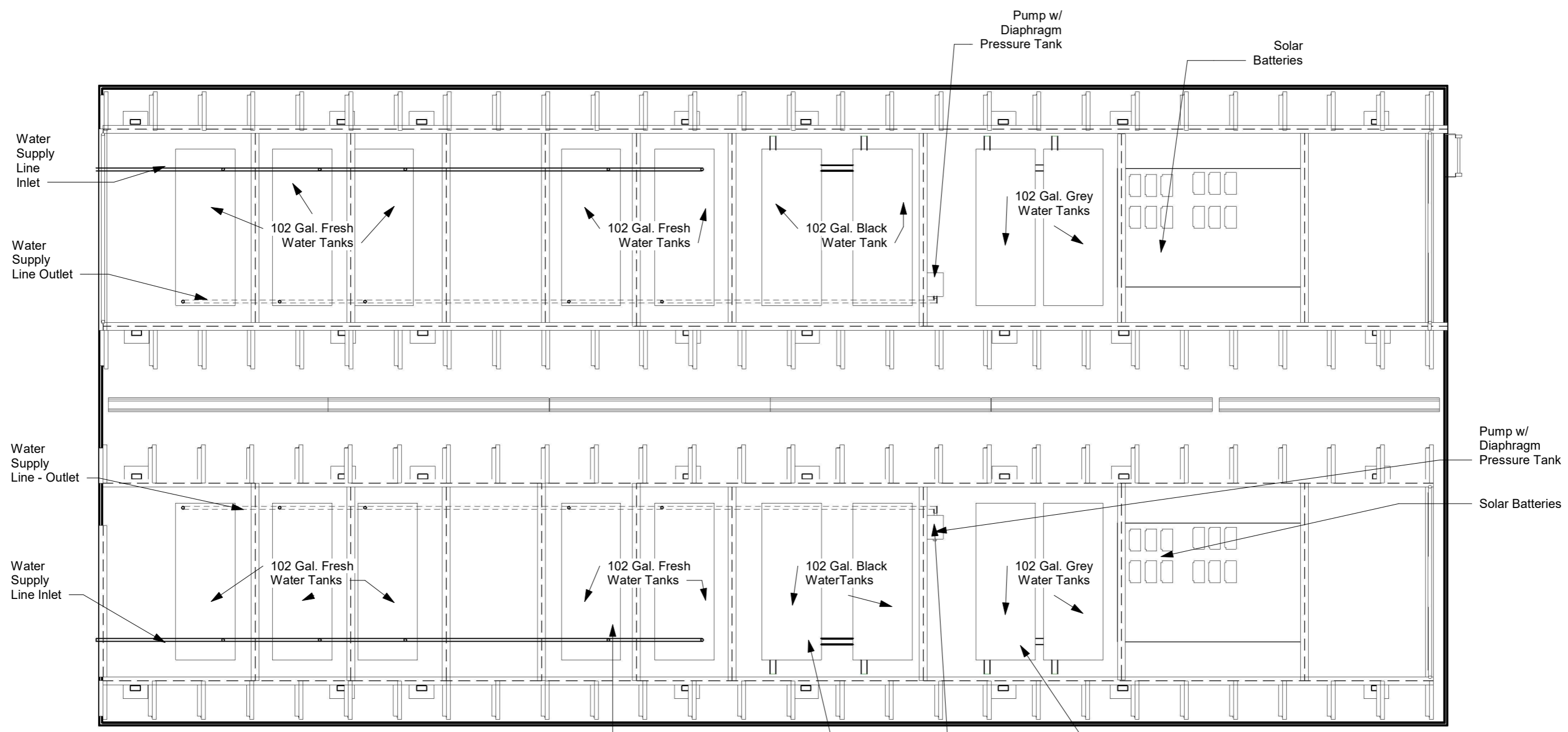

① Water tanks, Sewage Tanks, Grey Water tanks and diaphragm pressure tank  
 1/4" = 1'-0"

# Angel Landings

www.angellandings.com

Tel# 917-653-0551

Tanks can hold up to 2 weeks of fresh water, sewage, and grey water waste. Plan view

22001

1/18/2020

22 33 00 A1. Tank Less Water heater



The new degree of comfort®



Residential Electric  
Professional Classic  
Tankless Water Heaters

# Professional Classic® tankless electric water heaters offer continuous hot water

## Performance Features

- On demand, consistent and continuous hot water
- Compact and stylish with digital temperature control in increments of 1° ranging from 80°F to 140°F\*
- Robust copper immersion heating elements with brass top increases durability and are threaded for easy replacement
- Simple Installation
- Digital temperature display
- External controls to adjust temperature in increments of 1°\*

## Average GPM Usage by Application

Standard Hand Sink	0.5 GPM
Washing Machine	1 to 1.5 GPM
Water-Saver Shower Head	1.5 GPM
Dishwasher	1 to 2 GPM
Kitchen Sink	1 to 2 GPM
Standard Shower Head	2.0 GPM
Bath Tub	≥ 4 GPM
Whole-Home	Up to 6 GPM

Average Gallons Per Minute (GPM) based on 2010 Plumbing Standards

## Warranty

- 5-Year heating chamber and 1-year parts limited warranty

See Residential Warranty Certificate for complete information

\*RTEX-04 and RTEX-06 only show output temperature and are non-thermostatically controlled

MODEL NUMBER	TEMPERATURE RISE °F								
	0.5 GPM	1.0 GPM	1.5 GPM	2.0 GPM	2.5 GPM	3.0 GPM	4.0 GPM	5.0 GPM	6.0 GPM
<b>SINGLE POINT-OF-USE</b>									
RTEX-04	48°	24°	16°	12°	-	-	-	-	-
RTEX-06	75°	37°	25°	19°	-	-	-	-	-
<b>MULTIPLE APPLICATIONS</b>									
RTEX-08	+	55°	36°	27°	22°	18°	14°	-	-
RTEX-11	+	75°	50°	38°	30°	25°	19°	-	-
RTEX-13	+	89°	59°	44°	36°	30°	22°	-	-
RTEX-18	+	+	82°	62°	49°	41°	31°	25°	-
RTEX-24	+	+	109°	82°	66°	55°	41°	33°	27°
RTEX-27	+	+	+	92°	74°	62°	46°	37°	31°
RTEX-36	+	+	+	+	98°	82°	62°	49°	41°

+ Temperature electronically limited setting on adjustable thermostat on front cover

## POINT-OF-USE

For 0.5 GPM to 2.0 GPM Applications



RTEX-04, RTEX-06

## MULTIPLE APPLICATIONS

For 0.5 GPM to 6.0 GPM Applications



RTEX-08, RTEX-11, RTEX-13



RTEX-18



RTEX-24, RTEX-27



RTEX-36



Tested and certified by the Water Quality Association against NSF/ANSI 372 for lead free compliance.



RTEX-04, RTEX-06

### Unique Features:

- External Digital Display – shows outlet temperature
- Durable Copper Immersion single heating element, field serviceable
- Simple Installation – Bottom 1/2" NPT water connections



RTEX-08, RTEX-11, RTEX-13

### Unique Features:

- External Adjustable Digital Thermostatic Control with LED display (+/- 1 degree accuracy)
- Durable Copper Immersion two heating elements, field serviceable
- Simple Installation – 1/2 NPT adapters included; Side 1/2" compression water connections



RTEX-18

### Unique Features:

- External Digital Thermostatic Control with LED display (+/- 1 degree accuracy)
- Most advanced self-modulation, adjust power to meet hot water demand
- Durable Copper Immersion two heating elements, field serviceable
- Simple Installation – Bottom 3/4" NPT water connections

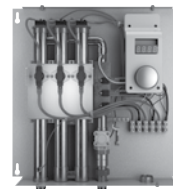

RTEX-24, RTEX-27

### Unique Features:

- External Digital Thermostatic Control with LED display (+/- 1 degree accuracy)
- Most advanced self-modulation, adjust power to meet hot water demand
- Durable Copper Immersion three heating elements, field serviceable
- Simple Installation – Bottom 3/4" NPT water connections

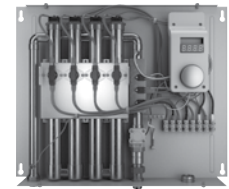

RTEX-36

### Unique Features:

- External Digital Thermostatic Control with LED display (+/- 1 degree accuracy)
- Most advanced self-modulation, adjust power to meet hot water demand
- Durable Copper Immersion four heating elements, field serviceable
- Simple Installation – Bottom 3/4" NPT water connections



INTEGRATED HOME COMFORT

Rheem.com



The new degree of comfort.



Residential Electric  
Professional Classic  
Tankless Water Heaters

## Specifications

DESCRIPTION	FEATURES							ROUGHING IN DIMENSIONS (SHOWN IN INCHES)					
	MODEL NUMBER	KW	AMPS	RECOMMENDED BREAKER SIZE	VOLTAGE	RECOMMENDED WIRE SIZE (CU)	MIN. FLOW (GPM)	MAX. FLOW (GPM)	HEIGHT	WIDTH	DEPTH	WATER CONN.	SHIP WEIGHT (LBS.)
<b>120V 1 HEATING CHAMBER</b>													
RTEX-04	3.5	29A	(1x30)A	120	10 AWG	0.3	1.5	5-7/8	10-7/8	2-3/4	1/2 NPT	4.5	
<b>240V* 1 HEATING CHAMBER</b>													
RTEX-06	5.5	25A	(1x25)A	220	10 AWG	0.3	2.0	5-7/8	10-7/8	2-3/4	1/2 NPT	4.5	
RTEX-08*	8.0	33A	(1x40)A	240	8 AWG	0.3	4.8	12-5/8	8-1/4	3-5/8	1/2 CF	7	
RTEX-11*	11.0	46A	(1x50)A	240	6 AWG	0.3	4.8	12-5/8	8-1/4	3-5/8	1/2 CF	8.5	
RTEX-13*	13.0	54A	(1x60)A	240	6 AWG	0.3	4.8	12-5/8	8-1/4	3-5/8	1/2 CF	8.5	
<b>240V* 2 HEATING CHAMBERS</b>													
RTEX-18*	18.0	75A	(2x40)A	240	8 AWG	0.3	7.0	18-1/4	14-1/2	3-1/2	3/4 NPT	14.78	
<b>240V* 3 HEATING CHAMBERS</b>													
RTEX-24*	24.0	100A	(3x40)A	240	8 AWG	0.3	7.0	18-1/4	17-5/8	3-1/2	3/4 NPT	17.8	
RTEX-27*	27.0	113A	(3x40)A	240	8 AWG	0.3	7.0	18-1/4	17-5/8	3-1/2	3/4 NPT	17.8	
<b>240V* 4 HEATING CHAMBERS</b>													
RTEX-36*	36.0	150A	(4x40)A	240	8 AWG	0.3	8.0	18-1/4	21-5/8	3-1/2	3/4 NPT	22.7	

\*240V units can be used on 208V single phase with 25% reduced temperature output. Please note per UL standards the rating plate and installation instructions will all be according to a 240V applied voltage. Check with local officials prior to derating the electrical infrastructure.

Product Specifications (all models)	Rated Pressure	25 PSI min., 150 PSI max.
	Certifications	ETL Listed to UL 499 and CSA
	Std. Temp. Settings	120°F (Adjustable 80°F-140°F)
	Temp. Accuracy	+/-1° at steady flow
	Turn-On	0.3 GPM

### Suggested Specifications

Unit shall have copper clad immersion heating element(s) with brass terminations for increased durability. External temperature control and display adjustable in 1° increments with a range of 80°-140°F. Display shall be capable of displaying setpoint temperature in Celsius or Fahrenheit temperature scales. Unit shall utilize a flow meter with a 0.3 gpm activation point and manage power based on actual flow rate and inlet temperature. Values should be processed 60 times per second. Unit shall be WQA certified lead free, certified to UL499 and CSA C22.2 No.64.

### Optional Inline Flow Regulator

- Enhanced outlet temperature control
- Install on the outlet side of the heater
- Limit maximum volume to the specified flow rate to ensure exiting temperature is within an acceptable range
- Flow Regulators for 1/2" and 3/4" NPT plumbing connections
- Flow range: 1 to 5 gallons per minute

RHEEM PART NUMBER	GPM RATING OF INSERTS PROVIDED	CONNECTION SIZE
RTE10001A	1.0, 1.5, 2.0	1/2" NPT
RTE10001B	2.0, 3.0, 4.0, 5.0	3/4" NPT

### Suggested Sizing Guide

MODEL NUMBER	FLOW REGULATOR PART NO.	GPM INSERT TO USE BASED ON INLET WATER TEMPERATURE			
		40°F	50°F	60°F	70°F
RTEX-04	N/A	N/A	N/A	N/A	N/A
RTEX-06	N/A	N/A	N/A	N/A	N/A
RTEX-08	RTE10001A	1.0	1.0	1.0	1.5
RTEX-11	RTE10001A	1.0	1.0	1.5	2.0
RTEX-13	RTE10001A	1.0	1.0	1.5	2.0
RTEX-18	RTE10001B	2.0	2.0	2.0	3.0
RTEX-24	RTE10001B	2.0	2.0	3.0	4.0
RTEX-27	RTE10001B	2.0	3.0	4.0	5.0
RTEX-36	RTE10001B	3.0	4.0	5.0	5.0

In keeping with its policy of continuous progress and product improvement, Rheem reserves the right to make changes without notice.

Rheem.com | 800.374.8806  
Manufacturers National Service Department  
400 Captain Neville Drive, Waterbury, CT 06705



INTEGRATED HOME COMFORT

22 13 01. Gray Water Tanks

22 13 00. Black Water Tanks

(888) 686-8265

LOWEST PRICES

BEST SHIPPING RATES



Products

HOME / RV TANKS / RV HOLDING TANKS / RV BLACK WATER HOLDING TANKS / 100 GALLON RV HOLDING TANK

## 100 GALLON RV HOLDING TANK

*rv black water tank, rv grey water tank, rv septic tank, camper sewage tank, travel trailer waste tank, camper grey water tank, motorhome holding tank*

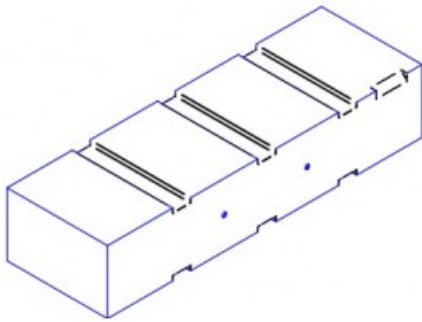

Hover to zoom

Images may be inaccurate. See specs table below to ensure accuracy.

### Quick Summary

PART#	MPN: 120100HD / Store ID: X7891982
DIMENSIONS	72" Length x 23" Width x 14.5" Height
LIQUID ACCESS	No
WEIGHT / SHIP CLASS	60 lbs. / Ship Class 150
SHIPS FROM	FL
DRAWING	<a href="#">Dura-Cast 120100HD-RHT Drawing</a>

Ideal for Grey / Black Water Use

Durable construction is resistant to dents, chips, and cracks

This tank is offered in three options: Blank with no fittings, optional installed 3" spinweld outlet, or optional spinweld fitting package (1-1/2" Inlet, 3" Outlet, and 1/2" Vent) available as add-ons

DIY fitting kit available for custom fitting placement

**Production lead time is 5 weeks - potentially longer. (This particular tank manufacturer is experiencing longer than usual delays in manufacturing)**

Custom fitting placement not available at this time.

Mounting straps are not offered on this tank.

Not intended for gasoline fuel storage.

~~\$676.54~~ **\$562.95**

**17% Off MSRP Guaranteed for 2 days only**

Qty: 
[ADD TO CART](#)
[SHIPPING QUOTE](#)

## ADD-ONS

Check items to add to the cart or **select all**

**Installed Dura-Cast RHT Standard Tank Fitting Package**

**DIY Fitting Kit for RV & Marine Tanks**

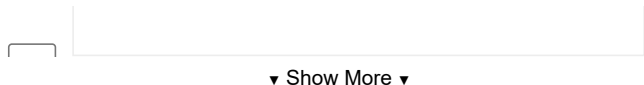

Description  
Specifications

- Custom fitting placement not available at this time.
- Mounting straps are not offered on this tank.
- Not intended for gasoline fuel storage.

**Dura-Cast 100 Gallon RV Holding Tank**, part# 120100HD-RHT is a natural white rv holding tank. This rv holding tank is used in a variety of mobile water holding storage applications including recreational vehicles, campers, tiny houses, and food trucks.

This rv holding tank is constructed with rotationally molded polyethylene resin. It's seamless construction makes it durable and resistant to cracks, chips, and ruptures. The poly tank was made with FDA approved resin that complies with FDA standards 21 CFR 177.1520 (1) 3.1 and 3.2 for the storage of potable water.

The Dura-Cast 100 gallon rv holding tank has a wall thickness of 1/4".

This plastic rv holding tank is available in sizes ranging from 5 to 202 gallons.

The National Tank Outlet is ready to help fulfill your rv holding tank needs. Contact our rv holding tank experts with your questions.

### FIND THIS RV HOLDING TANK IN

- Plastic Tank Manufacturers**
- Dura-Cast Tanks**
- Potable Water Tanks**
- Above Ground Tanks**
- RV Tanks**
- RV Holding Tanks**
- RV Grey Water Holding Tanks**
- RV Black Water Holding Tanks**

▼ Show More ▼

### SIZE COMPARISON



At Scale

STORE ID	X7891982
<b>Manufacturer Info</b>	
PRODUCT PART #	120100HD
MANUFACTURER	Dura-Cast
TECHNICAL DRAWING	<a href="#">Dura-Cast 120100HD-RHT Drawing</a>



Size Info	
CAPACITY (GALLONS)	100
DIMENSIONS	72" Length x 23" Width x 14.5" Height
WALL THICKNESS	1/4"
WEIGHT (LBS)	60
Resin Features	
COLOR	Natural White
MATERIAL	Polyethylene
FDA APPROVED RESIN	Yes (Food Grade, Potable)
UV INHIBITORS	No
MAX TEMP ALLOWED	130° F / 54° C
Physical Features	
PRODUCT TYPE	RV Holding Tank
TANK SHAPE	Rectangular
TANK USABILITY	Portable
ENVIRONMENT	Above Ground
PRESSURIZED USE	No
ANSI / NSF 61 APPROVED RESIN	Yes
Shipping Info	
SHIPPING LOCATIONS	Florida
SHIPPING ZIP CODES	33859
SHIP FREIGHT CLASS	150
PALLET TYPE	Standard (50 lbs.)



REVISION HISTORY

REV	DESCRIPTION	DATE	APPROVED

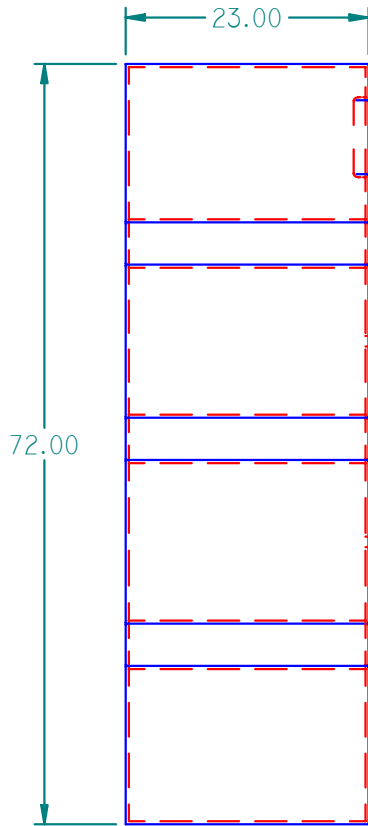

TANKS ARE DESIGNED TO BE USED IN A HORIZONTAL POSITION. RECTANGULAR TANKS USED IN VERTICAL POSITION MAY REQUIRE ADDITIONAL WALL THICKNESS OR EXTERNAL SUPPORT

TANKS ARE NOT RATED FOR GASOLINE OR AROMATIC SOLVENTS

TANK RESINS ARE FULLY UV STABILIZED

MOST SIZE TANKS ARE AVAILABLE IN STANDARD WALL THICKNESS SHOWN OR HEAVY DUTY

ALLOW +/- 1% ON TANK DIMENSIONS FOR OVERALL SIZE VARIANCES

VENT HOLE ON TANK WILL BE WELDED SHUT IF NOT USED FOR FITTING LOCATION

TANK PLASTIC RESIN IS FDA COMPLIANT BASED ON MANUFACTURER'S SPECIFICATIONS

TANKS MEET ABYC AND USCG REQUIREMENTS FOR MARINE WATER AND HOLDING TANK APPLICATIONS

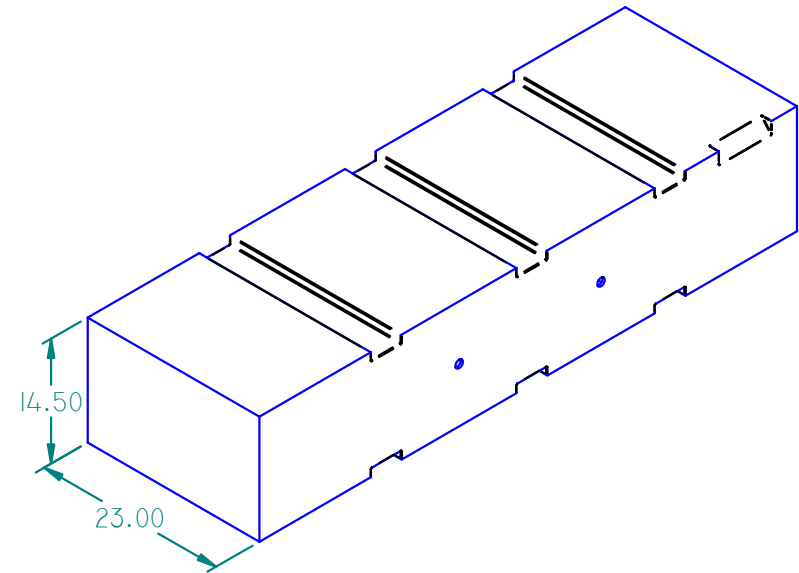

ISO VIEW I20100

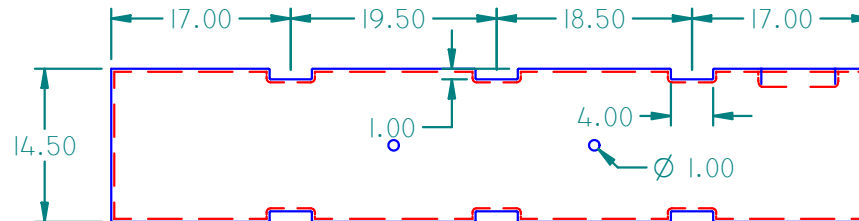
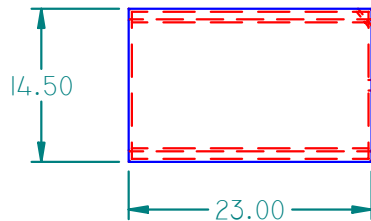

TANK CAPACITY: 96 GALLONS

	NAME	DATE
DRAWN	MPUTT	1/27/2004
CHECKED		
ENG APPR		
MGR APPR		



16160 Hwy 27 Lake Wales, FL 33859

TITLE 96 GALLON PLASTIC TANK	
SIZE A	MATERIAL: LMDPE NATURAL
	REV

FILE NAME: I20100.DFT

WALL THICKNESS: .290"

UNLESS OTHERWISE SPECIFIED  
DIMENSIONS ARE IN INCHES  
ANGLES ±0.5°  
2 PL ±0.125" 3 PL ±0.060"

PART#: I20100	WEIGHT: 60.394 LBM	SHEET 1 OF 1
---------------	--------------------	--------------

23 12 00. Fresh Water Tanks

(888) 686-8265

LOWEST PRICES

BEST SHIPPING RATES



Products

HOME / 102 GALLON RV FRESH WATER TANK

## 102 GALLON RV FRESH WATER TANK

camper freshwater tank, portable rv tank, travel trailer water tank, tiny house water tank, food truck water tank, motorhome water tank

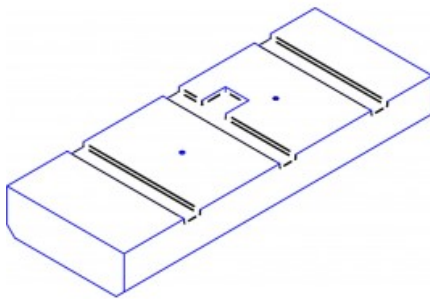

Click to expand

Images may be inaccurate. See specs table below to ensure accuracy.

### Quick Summary

PART#	MPN: 103102 / Store ID: X4852144
DIMENSIONS	79" Length x 30" Width x 10.5" Height
LIQUID ACCESS	No
WEIGHT / SHIP CLASS	59 lbs. / Ship Class 150
SHIPS FROM	FL
DRAWING	<a href="#">Dura-Cast 103102-RWT Drawing</a>

BPA Free & FDA Approved for Drinking

Durable construction is resistant to dents, chips, and cracks

DIY fitting kit available for custom fitting placement

**Production lead time is 5 weeks - potentially longer. (This particular tank manufacturer is experiencing longer than usual delays in manufacturing)**

Custom fitting placement not available at this time.

Mounting straps are not offered on this tank.

Not intended for gasoline fuel storage.

~~\$581.04~~ **\$483.99**

**17% Off MSRP Guaranteed for 2 days only**

Qty:

ADD TO CART

SHIPPING QUOTE

### ADD-ONS

Check items to add to the cart or **select all**

**Installed Dura-Cast RWT Standard Tank Fitting Package**

**DIY Fitting Kit for RV & Marine Tanks**

▼ Show More ▼

Description  
Specifications

Custom fitting placement not available at this time.

Mounting straps are not offered on this tank.

Not intended for gasoline fuel storage.

**Dura-Cast 102 Gallon RV Water Tank**, part# 103102-RWT is a natural white rv water tank. This rv water tank is used in a variety of mobile water storage applications including recreational vehicles, campers, tiny houses, and food trucks.

This rv water tank is constructed with rotationally molded polyethylene resin. It's seamless construction makes it durable and resistant to cracks, chips, and ruptures. The poly tank was made with FDA approved resin that complies with FDA standards 21 CFR 177.1520 (1) 3.1 and 3.2 for the storage of potable water.

The Dura-Cast 102 gallon rv water tank has a wall thickness of 1/4" and can be ordered blank, blank with a diy fitting kit, with standard fittings, and with standard fittings & lid.

This plastic rv water tank is available in sizes ranging from 1 to 202 gallons.

The National Tank Outlet is ready to help fulfill your rv water tank needs. Contact our rv water tank experts with your questions.

FIND THIS RV WATER TANK IN

- Plastic Tank Manufacturers**
- Dura-Cast Tanks**
- Potable Water Tanks**
- Above Ground Tanks**
- RV Tanks**
- RV Fresh Water Tanks**
- Dura-Cast RV Tanks**
- Dura-Cast RV Fresh Water Tanks**

SIZE COMPARISON



At Scale

STORE ID	X4852144
<b>Manufacturer Info</b>	
PRODUCT PART #	103102
MANUFACTURER	Dura-Cast
TECHNICAL DRAWING	<a href="#">Dura-Cast 103102-RWT Drawing</a>
<b>Size Info</b>	
CAPACITY (GALLONS)	102

DIMENSIONS	79" Length x 30" Width x 10.5" Height
WALL THICKNESS	1/4"
WEIGHT (LBS)	59
<b>Resin Features</b>	
COLOR	Natural White
MATERIAL	Polyethylene
FDA APPROVED RESIN	Yes (Food Grade, Potable)
UV INHIBITORS	No
MAX TEMP ALLOWED	130° F / 54° C
<b>Physical Features</b>	
PRODUCT TYPE	RV Water Tank
TANK SHAPE	Rectangular
TANK USABILITY	Portable
ENVIRONMENT	Above Ground
PRESSURIZED USE	No
ANSI / NSF 61 APPROVED RESIN	Yes
<b>Shipping Info</b>	
SHIPPING LOCATIONS	Florida
SHIPPING ZIP CODES	33859
SHIP FREIGHT CLASS	150
PALLET TYPE	Standard (50 lbs.)



REVISION HISTORY

REV	DESCRIPTION	DATE	APPROVED

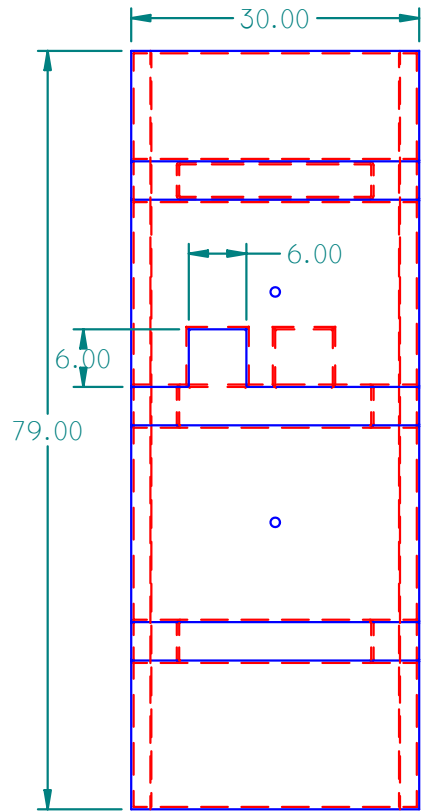

TANKS ARE DESIGNED TO BE USED IN A HORIZONTAL POSITION. RECTANGULAR TANKS USED IN VERTICAL POSITION MAY REQUIRE ADDITIONAL WALL THICKNESS OR EXTERNAL SUPPORT

TANKS ARE NOT RATED FOR GASOLINE OR AROMATIC SOLVENTS

TANK RESINS ARE FULLY UV STABILIZED

MOST SIZE TANKS ARE AVAILABLE IN STANDARD WALL THICKNESS SHOWN OR HEAVY DUTY

ALLOW +/- 1% ON TANK DIMENSIONS FOR OVERALL SIZE VARIANCES

VENT HOLE ON TANK WILL BE WELDED SHUT IF NOT USED FOR FITTING LOCATION

TANK PLASTIC RESIN IS FDA COMPLIANT BASED ON MANUFACTURER'S SPECIFICATIONS

TANKS MEET ABYC AND USCG REQUIREMENTS FOR MARINE WATER AND HOLDING TANK APPLICATIONS

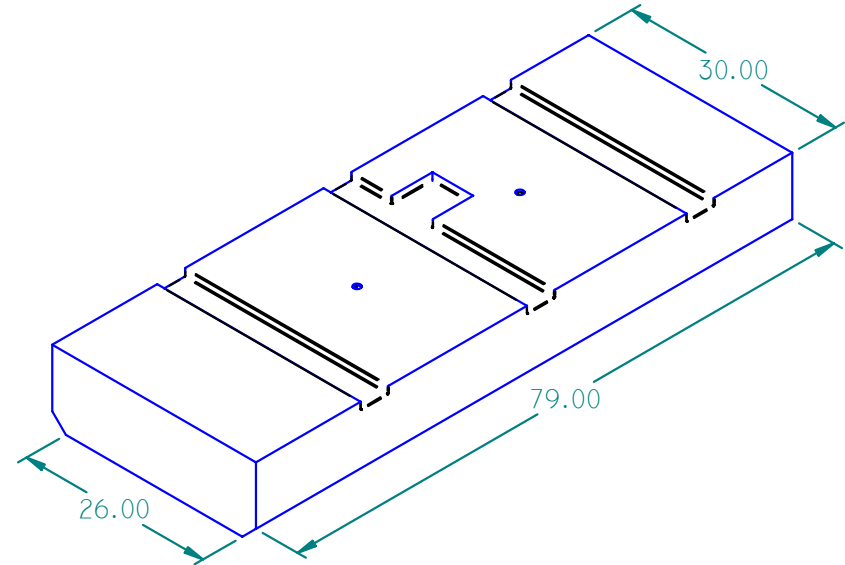

ISO VIEW 103102

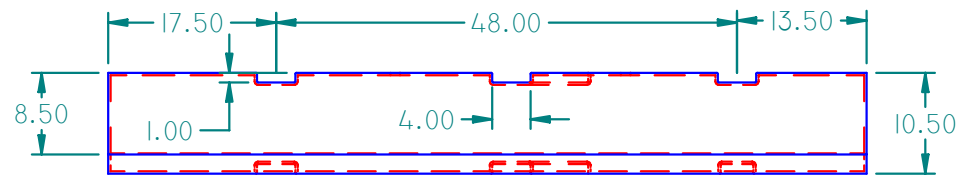
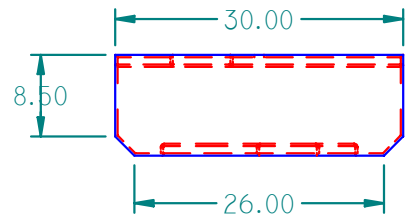

TANK CAPACITY: 100 GALLONS

	NAME	DATE
DRAWN	MPUTT	1/28/2004
CHECKED		
ENG APPR		
MGR APPR		



16160 Hwy 27 Lake Wales, FL 33859

TITLE 100 GALLON PLASTIC TANK		REV
SIZE A	MATERIAL: LMDPE NATURAL	

FILE NAME: 103102.DFT

WALL THICKNESS: .250"

UNLESS OTHERWISE SPECIFIED DIMENSIONS ARE IN INCHES ANGLES ±0.5° 2 PL ±0.125" 3 PL ±0.060"

PART#: 103102	WEIGHT: 59.572 LBM	SHEET 1 OF 1
---------------	--------------------	--------------

23 40 00 E3 Toilet





Feedback

## **DOMETIC 4310**

### TOILET, CHROME FLUSH HANDLE - BONE

With its European styling and 100 percent vitreous china construction, Dometic 4310 series toilets are perfect for motorhomes, bus conversions, and mobile public restrooms. From the leader in toilet sanitation, these RV toilets offer soft lines and gracious curves along with abundant features including a powerful electronic flush.

---

#### **ECO-FRIENDLY**

---

#### **POWERFUL FLUSH**

ELECTRONIC TRIGGER

---

#### **COMFORTABLE**

RESIDENTIAL SEAT

ITEM NR. 9108684377 (302431131)

## AT-HOME COMFORT

With an enameled, elongated seat, residential height and a lustrous high-fired vitreous china fixture, Dometic 4400 series toilets make you feel right at home. Electric wall switch offers veratility by allowing the use to add water or flush at the touch of a button.



Feedback



**AT HOME COMFORT**

Elongated residential-style seat



Feedback

## ...AND MORE

---

- Eco-friendly, low-water consumption at 0.33 gal. per flush
- Electronic flush handle in chrome finish
- Elongated residential-style seat for the comfort of home
- White or bone colors
- Optional hand sprayer
- Gravity flush system

## SLEEK AND POWERFUL

With its European styling and 100 percent vitreous china construction, the Dometic 4310 Premium All-Ceramic Toilet is perfect for motorhomes, bus conversions, and mobile public restrooms. From the leader in toilet sanitation, these RV toilets offer soft lines and gracious curves along with abundant features. With a powerful

bowl-clearing gravity flush triggered by the electronic handle or wall-mounted switch it's both simple and convenient to use. The elongated residential-style seat provides all important comfort.

## SPECIFICATIONS

### GENERAL

**SKU number** 9108684377

**Model** 4310

**Model on label** 4310

**US Item Name** 302431131

**SKU replaced by** 9108684384

**Scope of delivery** Toilet, Mounting Kit, Mounting Hardware, Manual

**Product Description** Toilet, Chrome Flush Handle - Bone

### DIMENSIONS

**Dimensions product depth** 22 1/2 "

**Dimensions product height** 19 "

**Dimensions product width** 14 3/4 "

**Net weight** 66 lbs

**Rough In Dimensions** 11 Inch Minimum

### ADDITIONAL

**Color** Bone

**Flush Method** Electric Handle

**Bowl Material** Ceramic

**Base Material** Ceramic

**Seat Height** 19 "

**Seat Type** Enameled Wood

**Seat Close** Standard

### LOGISTICS

**EAN-13** 0713814076191

**Dimensions parcel depth** 27 "

**Dimensions parcel height** 26 "

**Dimensions parcel width** 19 "

**Parcel weight** 72.06 lbs



**WARNING** This product can expose you to chemicals including arsenic, which is known to the State of California to cause cancer. For more information, go to [www.P65Warnings.ca.gov](http://www.P65Warnings.ca.gov).

## DOCUMENTS

Download



### DECLARATION OF CONFORMITY

Doc 20190425 FC GRAV

22 11 00  
Water Pump w/  
Diaphragm pressure tank

# High Volume Water System Pumps

## 2840 Series High Volume Water Pressure System



Provides a smooth flow of pressurized water for kitchen, bathroom, washer/dryer, ice maker and filtered water. 3.5 GPM (13.5 LPM) models supply water systems with up to seven valves, while 4.5 GPM (17 LPM) models supply up to ten valves.

### FEATURES & BENEFITS

- Integrated pump and accumulator tank system
- Compact design installs easily in convenient locations
- Runs dry without damage
- NSF approved for drinking water
- Self-priming up to 10' (3m)
- Includes assorted ports for easy installation
- Strainer included to protect pump from debris

### SPECIFICATIONS

Size:	7.2" high x 11.3" wide x 12.8" diameter (191mm x 286mm x 325mm)
Weight:	8.8lb (4kg)
Instruction Sheet:	81000 290

MODEL	VOLTS	GPM (LPM)	PRESSURE SHUT OFF	MAX AMPS
2840 100	12V DC	4.5 (17)	40 psi (2.8 bar)	10A
10 valves - Handles washer/dryer, ice maker, filtered water, two baths, and kitchen				
2840 110	12V DC	3.5 (13.5)	40 psi (2.8 bar)	8A
7 valves - Handles washer/dryer, ice maker, filtered water, one bath, and kitchen				
2840 300	24V DC	4.5 (17)	40 psi (2.8 bar)	5A



Addition items can include:  
portable macerator pump....

# Waste & Macerator Pumps

## Portable RV Waste Pump



### SPECIFICATIONS

Ports:	3/4" (19mm) garden hose (male)
Impeller:	Jabsco nitrile compound
Chopper:	Stainless steel
Case Size:	5.5" high x 13" long x 12" wide (139mm x 330mm x 305mm)
Weight:	6lb (2.8kg)

Designed to greatly improve one of the least desirable functions of the RV experience. Cleanly handle both the black and gray water from your holding tanks with this new self-priming, powerful macerator pump. The pump housing is designed to connect to the standard 3" sewer adapter. Power leads with plug may be permanently attached to vehicle, or battery clips may be attached for complete portability.

*Note: Some vehicles require an angle adapter for proper fit. Use this product in accordance with EPA Sanitary Regulations.*

### FEATURES & BENEFITS

- Connects directly to the RV waste outlet
- Eliminates the 3" (76mm) sewer hose
- Discharges through a garden hose
- Rinses water and back-wash valve
- Remote on/off switch and 6' (1.8m) harness
- Pumps tanks empty up to 50' (15m)
- Dumps tanks to any sewer access
- Easy clean-up and rugged storage case

MODEL	VOLTS	GPM (LPM)	AMPS	OUTLET
18555 000A	12V DC	13 (49)	16A	3/4" (19mm) NGH

Note: Thetford outlet requires an adapter

## 18550 Series Macerator Pump



### SPECIFICATIONS

Outlet Port:	1" (25mm) hose barb
Impeller:	Jabsco nitrile compound
Chopper:	Stainless steel
Weight:	12V DC version: 5lb (2.3kg) 115V AC version: 19lb (8.6kg)

### FEATURES & BENEFITS

- RV Macerator pump can empty a 30-gallon (115 L) holding tank in three minutes
- Grinds waste into small particles for easy disposal
- Self-priming
- Pump can be permanently installed for easy holding tank evacuation into a toilet or plumbing clean-out access

MODEL	INLET	GPM (LPM)	VOLTS	AMPS	FUSE/BREAKER
18550 000A	3" (75mm) hose barb	13 (49)	12V DC	16A	20A
18690 0010	3" (75mm) hose barb	13 (49)	115V AC	5A	7A
18550 200A	1.5" (38mm) hose barb	13 (49)	12V DC	16A	20A
18690 0000	1.5" (38mm) hose barb	13 (49)	115V AC	5A	7A

22 33 00 A1 Kitchen Sink

➔ **DOMETIC**

**VA350, VA910, VA928, VA930,  
VA7306, VA8005, VA8006, CE99 B410**

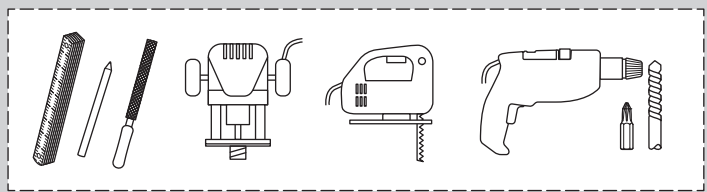
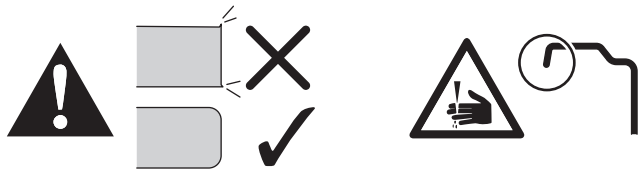

[documents.dometic.com](http://documents.dometic.com)

**VA350**



**mm**

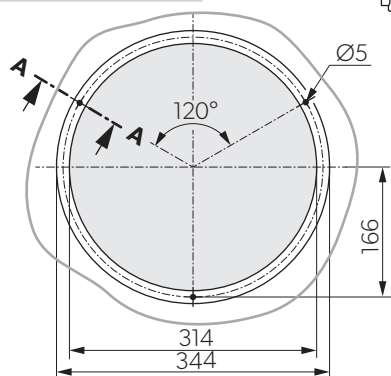
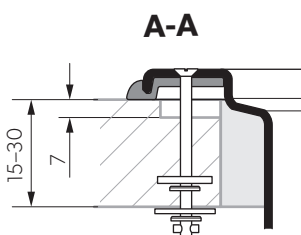

**VA910**



**mm**

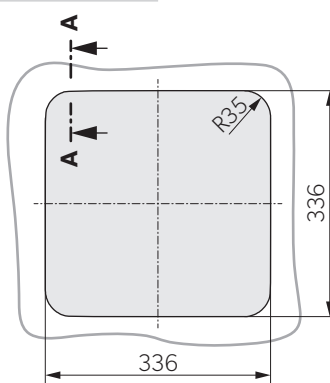
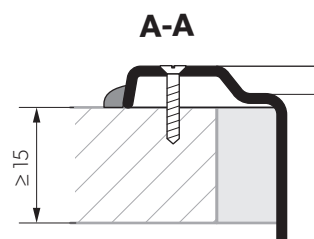

**VA928**



**mm**

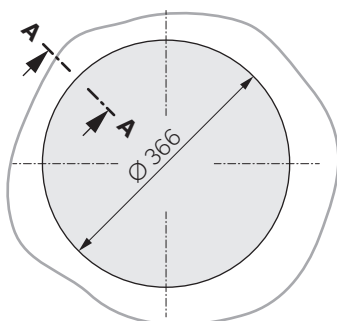
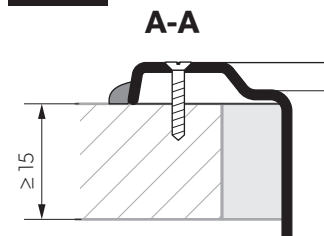

**VA930**



**mm**

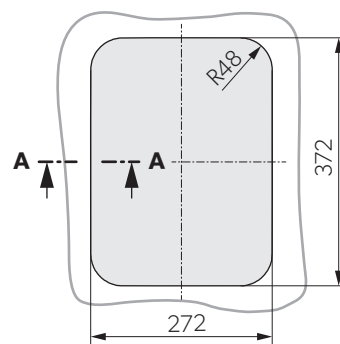
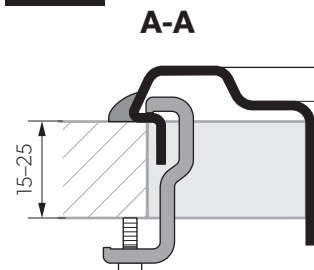

**CE99 B410**  
(SNG 4133)



**mm**

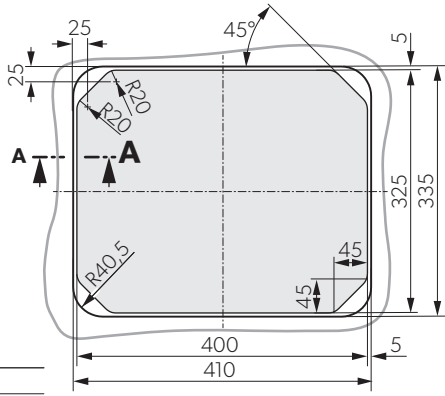

**A-A**

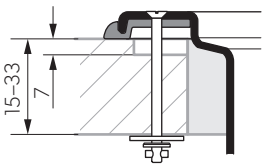

**VA7306**  
EMEA OEM



**mm**

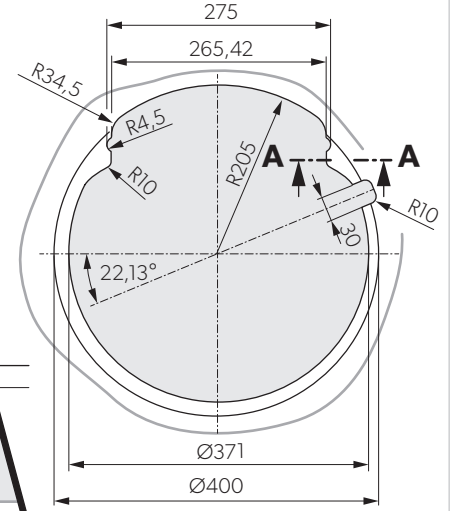

**A-A**

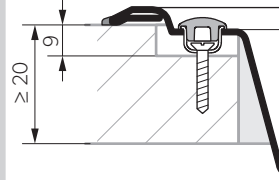

**VA7306**  
(SNG 420)



**mm**

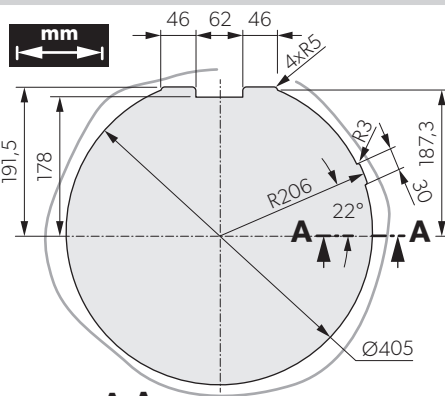

**A-A**

**A-A**

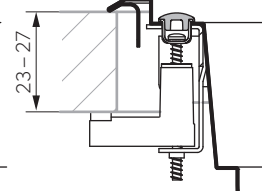
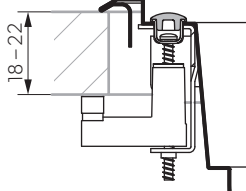

**VA7306**  
US



**inch**

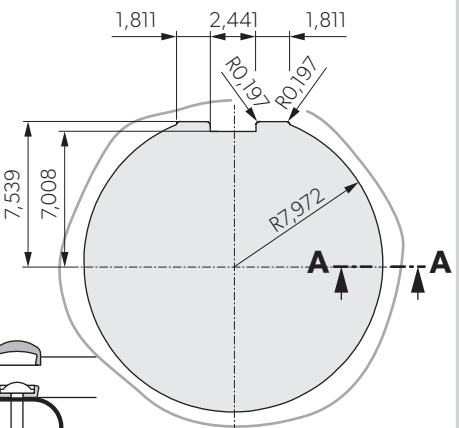

**A-A**

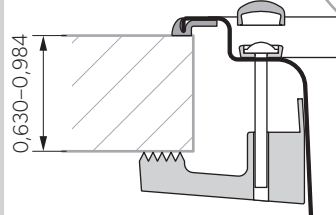

**VA8005**  
(SNG 4237)



**mm**

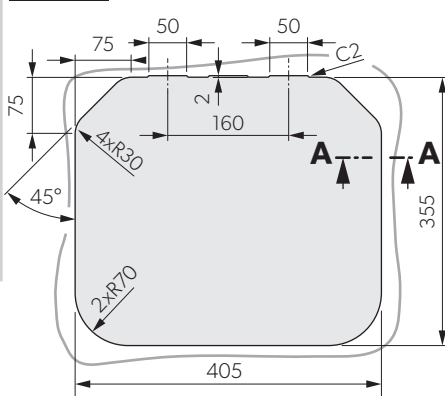

**A-A**

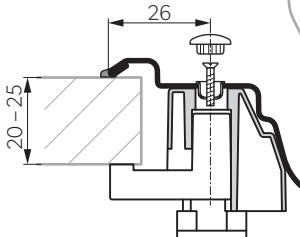

**VA8006**  
(SNG 4244)



**mm**

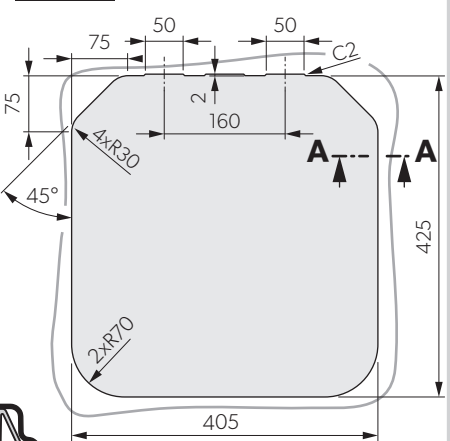

**A-A**

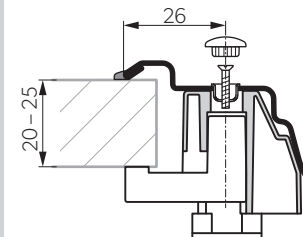

**YOUR LOCAL DEALER**  
dometic.com/dealer

**YOUR LOCAL SUPPORT**  
dometic.com/contact

**YOUR LOCAL SALES OFFICE**  
dometic.com/sales-offices

A complete list of Dometic companies, which comprise the Dometic Group, can be found in the public filings of:  
**DOMETIC GROUP AB** Hemvärnsgatan 15 SE-17154 Solna Sweden

Incinerator Toilet (for shore connection only).  
This will remove the use of black water tanks.

# Cinderella®

 Made in Norway

## Cinderella Comfort Model Comfort NA



**Cinderella Comfort Installation Manual**  
Languages: English, French

## Contents

Contents	Page 2
Included Parts	Page 3
Required Tools and Materials	Page 3
Specifications and Requirements	Page 4
Toilet Diagram	Page 5
Before Installation	Page 6
Planning Your Ventilation	Page 6
Installing the Outlet Air Pipe	Page 7–8
Installing the Inlet Air Pipe	Page 9–10
Finalizing the Installation	Page 11

## Sommaire (français)

Pièces incluses	Page 12
Outils et accessoires nécessaires	Page 12
Caractéristiques et exigences	Page 13
Schéma de les toilettes	Page 14
Avant l'installation	Page 15
Préparation de la ventilation	Page 15
Installation du tuyau d'évacuation d'air	Page 16-17
Installation du tuyau d'admission d'air	Page 18-19
Finalisation de l'installation	Page 20



## Parts Included

- 1 pc. Cinderella Comfort
- 1 box Original paper bags (500 bags)
- 1 pc. Outlet air pipe, diameter 4 $\frac{5}{16}$  in. x 2 ft. (110 mm x 600 mm)
- 1 pc. Inlet air pipe, diameter 4 $\frac{5}{16}$  in. x 1 $\frac{1}{2}$  ft. (110 mm x 450 mm)
- 1 pc. T-piece 90°, diameter 4 $\frac{5}{16}$  in. (110 mm)
- 1 pc. Ventilator cowl
- 1 pc. Weather cap
- 1 pc. User manual
- 1 pc. Installation manual



## Required Tools

- Drill
- Hole saw 4 $\frac{9}{8}$  in. (111 mm), for cutting holes for outlet air pipe and inlet air pipe
- Hole saw 6 $\frac{5}{8}$  in. (168 mm), for cutting hole for inlet air vent
- Long drill bit for drilling pilot hole through wall
- Saw
- Tape measure
- Marker pen
- Rasp or file

We highly recommend this installation kit for first-time or inexperienced installers. It includes the ventilation pipes and clamps you will need to perform a normal installation in combination with the parts included with your toilet. Contact your reseller for purchase information.





All safety instructions in this manual are marked with this symbol. Please be sure to pay close attention to all instructions given in this manual, especially when you see this symbol.

**IMPORTANT NOTE:** Read this entire installation manual prior to installation. The homeowner should keep this installation manual for future references. Visit [www.cinderellaeco.com/installation](http://www.cinderellaeco.com/installation) for detailed step-by-step animations for the installation of your new toilet. It can be a good idea to look at these animations prior to installing your new Cinderella Comfort toilet. They can be a useful tool in addition to this manual.

## Electrical Specifications and Requirements

**IMPORTANT NOTE:** This appliance must be installed in accordance with National Electrical Codes, as well as all state, municipal and local codes. The correct voltage, frequency and amperage must be supplied to the appliance from a dedicated, grounded circuit which is protected by a properly sized circuit breaker. The proper voltage, frequency and amperage are listed in this manual and on the product rating plate on the back of the toilet.

The toilet is delivered with a 15 amp NEMA 6-15 plug and chord. To supply sufficient power to the unit as delivered, it will require a Nema 6-15R receptacle on a dedicated grounded circuit, with at least 10 amps of available power at 220 V AC. If you do not have the appropriate receptacle available, please contact a licensed electrician to assist with your installation.

- Power Supply 240/220 V AC, 60 Hz
- Current 10 amp
- Power Consumption 2000W

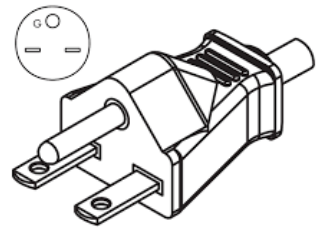

**15 AMPERE-250 VOLT<sup>†</sup>  
(NEMA 6-15P) PLUG**

**IMPORTANT NOTE:** Cinderella Comfort has a power consumption level of approximately 2000W while incinerating, which may be sustained over periods exceeding an hour at a time. Make sure that your electrician takes this electrical load into consideration.

**POWER CONVERTERS:** Power converters are not recommended for use with your Cinderella product. Cinderella Comfort has a maximum power consumption level of 2000W, which may be sustained over periods exceeding an hour at a time. Power converters with a “peak consumption” level of 2000W may be unable to maintain this power output and become overloaded, damaged or unsafe if used with your Cinderella Comfort.

**BATTERIES, GENERATORS and SOLAR PANELS** are not sufficient as a power source for Cinderella Comfort.

## Environmental Requirements

- Ambient temperature range: -5–105°F [-20–40°C]
- Operating altitude: Tested to 8,200 feet [2,500 m]



When the Cinderella Comfort is installed, minimum clearance to combustible construction must be:

- 2 in. from sides
- 2 in. from rear
- 18 in. from flue pipe, [see NFPA-82 for reduced clearances].

# Cinderella Comfort Dimensions

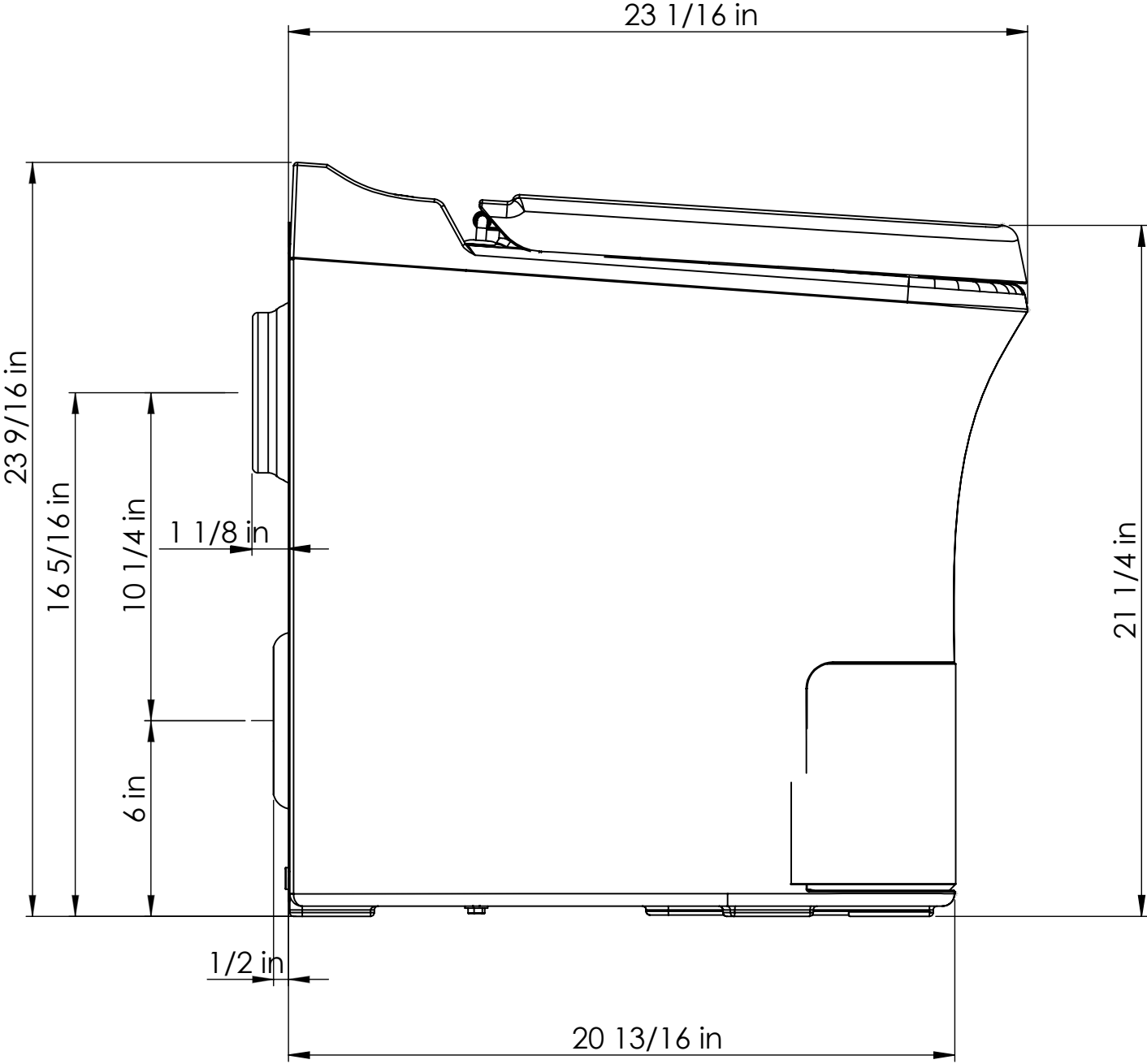

# Before Installation

Cinderella Comfort sets an entirely new standard of comfort and convenience among incineration toilets. This is due largely to its ground-breaking new air circulation system, which supplies all air necessary for incineration from exterior air, and thus does not impact the air pressure and temperature of the room in any way.

Cinderella Comfort is approved for use in bathrooms/wet rooms (IP 34 classified), but water must not be splashed over the external parts of the toilet. For more information about rules for installations in wet rooms, please consult a plumber.

The toilet must be placed on a firm and level base. Your Cinderella Comfort can be installed on a heated floor as well as in an unheated room. Always use the supplied ventilator cowl on the outlet air pipe. The ventilator cowl is designed to ensure good air flow and minimal back pressure. If the vent pipe is to be enclosed (using sheet metal etc.), the end of the pipe must extend at least 15¾ in. (400 mm) above the enclosure, see fig. 1.

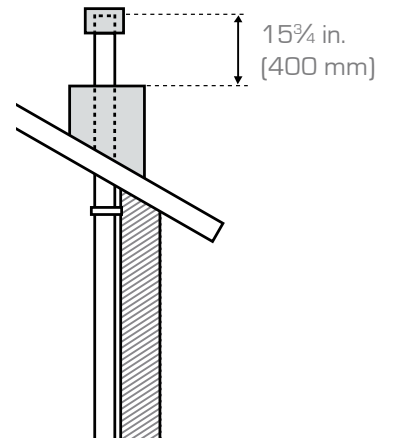

fig. 1



Warning: Before cutting any holes, always check that you will not hit any electrical wiring or water pipes. Failure to follow safety precautions may cause serious injury or death.

# Planning Your Ventilation

The first step in planning the installation is deciding how to install the outlet air pipe. There are several ways of installing the outlet pipe, but it is important to maintain good airflow and not create back pressure by installing too many bends or exceeding the maximum pipe length.

It is recommended to install pipe straight up above the roof without any additional bends, as shown below in alternatives 1 and 2. Incorrect installation may cause poor incineration, odors and wear of the product. Ensure that installation is performed in compliance with electrical and building regulations. If you are unsure of this, contact a professional tradesman.

### Alternative 1:

If the outlet air pipe will go straight out through an exterior wall, the toilet should be placed about 2 in. (50 mm) from the wall.

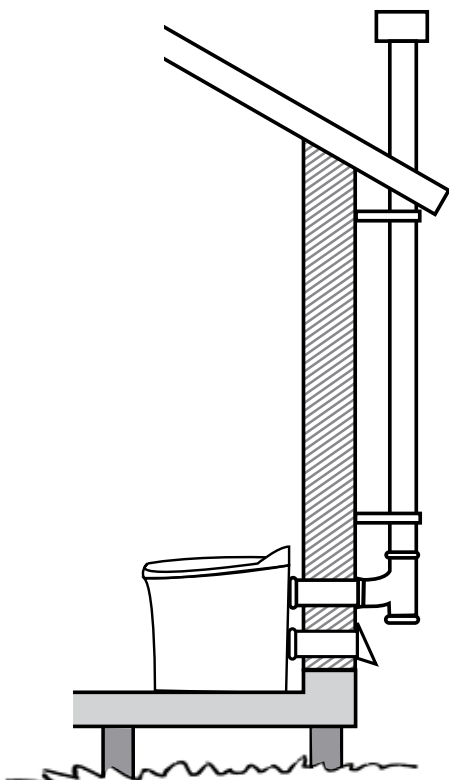

fig. 2

### Alternative 2:

If the outlet air pipe will go through the ceiling, the T-piece will require about 9 in. (230 mm) of space behind the toilet. This means that the toilet must be installed further away from the wall.

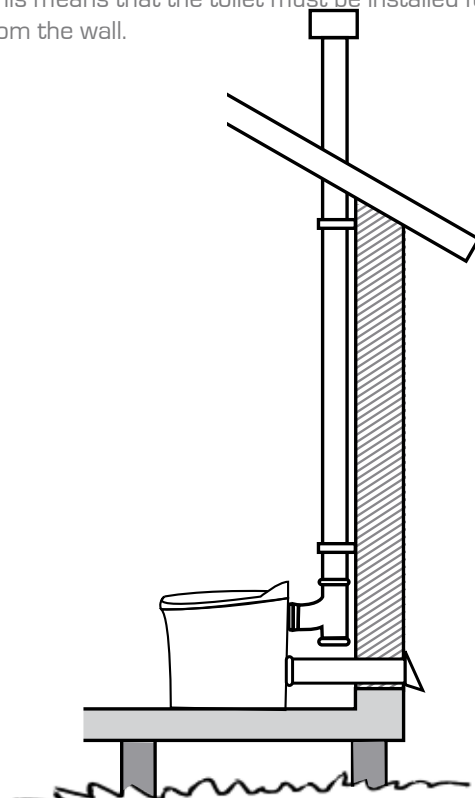

fig. 3

# Installing the Outlet Air Pipe

It is important to ensure that the pipe has a diameter of  $4\frac{5}{16}$  in. (110 mm) all the way from the toilet to the ventilator cowl. The inside of the pipe must be smooth, preferably of a PP-type. Do not use any flexible ducts or pipes with a diameter of less than  $4\frac{5}{16}$  in. (110 mm). The supplied ventilator cowl must be used. The length of the straight, vertical pipe MUST NOT exceed:

- 18 ft. (5.5 meters)
- 15 ft. (4.5 meters) if a pipe bend has been installed.

The pipe must extend at least  $15\frac{3}{4}$  in. (400 mm) above the roof at the point where it is fed through the roof, in order to secure the best possible air flow. A horizontal pipe with a maximum length of 2 ft (600 mm) may be installed directly into the toilet, the supplied pipe should be used. Try to install the outlet air pipe vertically, or as nearly vertical as possible.

**IMPORTANT NOTE:** Do not use any  $90^\circ$  bends in addition to the T-bend. Use no more than two  $45^\circ$  bends or two  $30^\circ$  bends when installing the outlet air pipe; see example (fig 6).

Three examples of outlet air pipe installations.

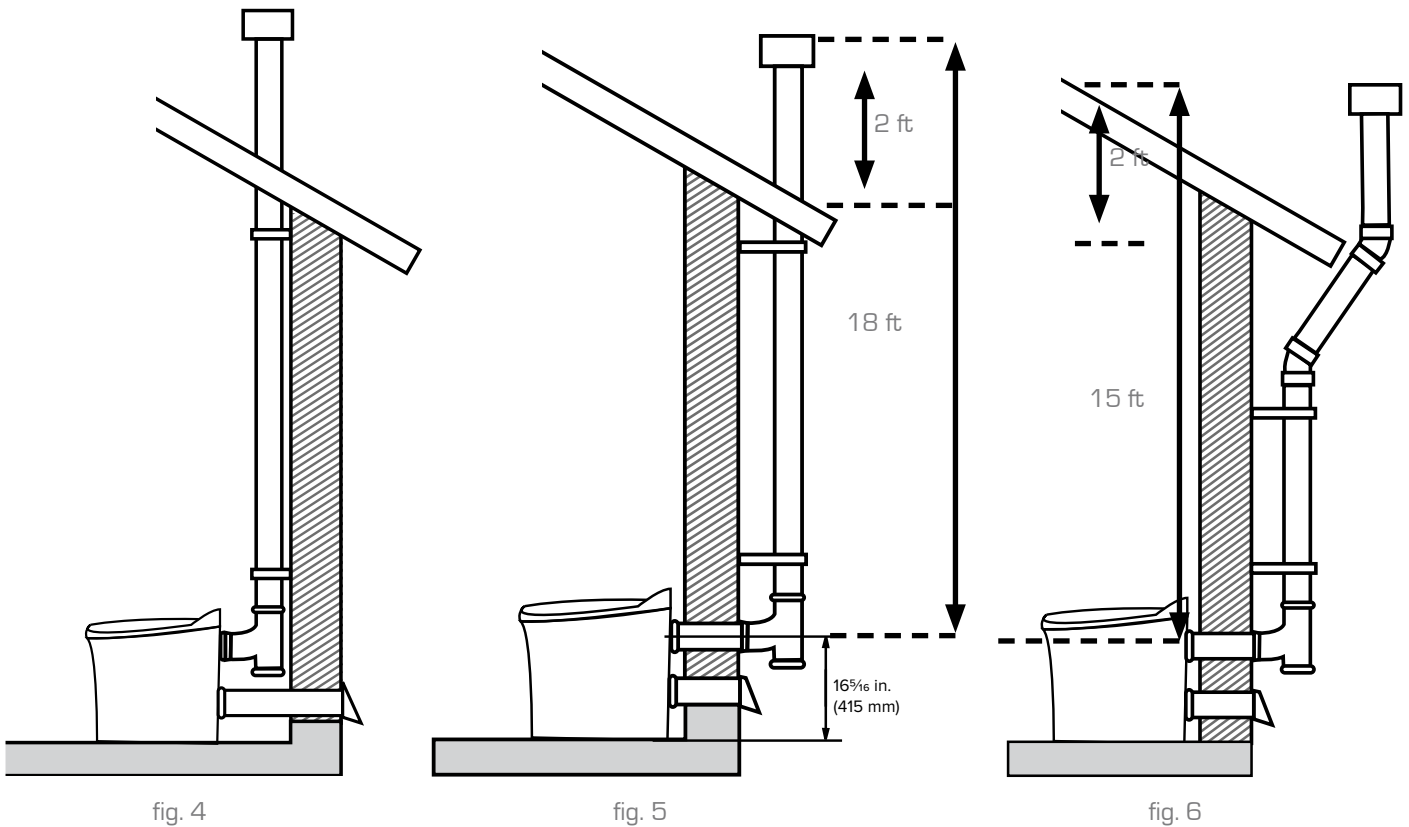

**IMPORTANT NOTE:** Each Cinderella Comfort toilet must have its own outlet air pipe.

## Installation of Bends in the Outlet Air Pipe

If you need to have bends in the outlet air pipe in order to pass around a window or an overhanging roof (see fig. 7), the following guidelines apply:

- If the pipe is installed at an angle of 30°, the total length of the angled part of the pipe must not exceed 5 ft. (1.5 m).
- If the pipe is installed at an angle of 45°, the total length of the angled part of the pipe must not exceed 3 ft. 4 in. (1.0 m).

**IMPORTANT NOTE:** If you must install bends, use no more than two 45° bends or two 30° bends. The maximum total length of the pipe may not exceed 15 ft. (4.5 m).

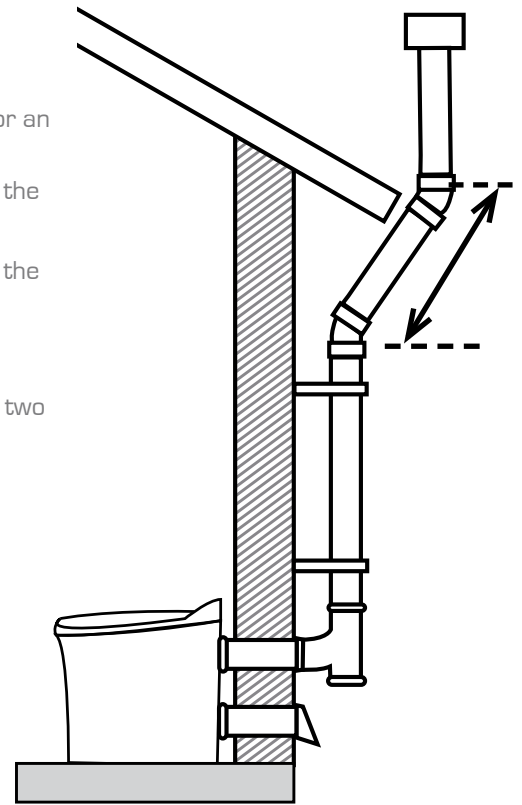
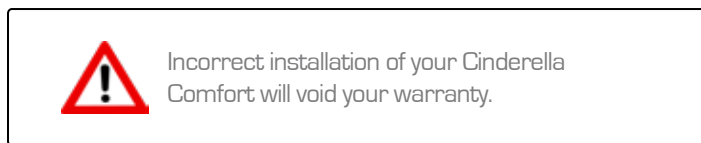

fig. 7

## Installing the Outlet Air Pipe through a Wall

Make a mark on the wall  $16\frac{5}{16}$  in. (415 mm) from the floor in the Cinderella's centerline. Pre-drill with a long drill bit through the interior and exterior wall in the center of where you will drill your  $4\frac{5}{16}$  in. (110 mm) hole. Make sure you are holding the drill at 90 degrees to the wall. Expand the hole with the  $4\frac{3}{8}$  in. (111 mm) diameter hole saw. Install the supplied short air pipe through the wall with the beveled end towards the Cinderella, see fig. 8.

Make a mark  $1\frac{1}{8}$  in. (35 mm) from the beveled end of the pipe to indicate how far the pipe should be pushed into the toilet; see fig. 9.

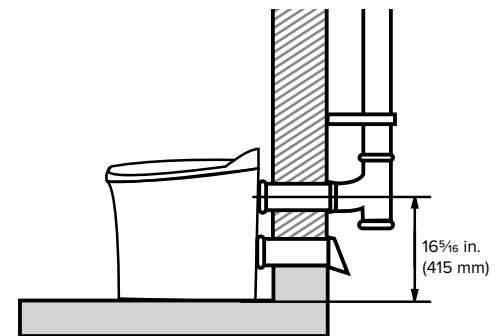

fig. 8

## Installing the Outlet Air Pipe through the Ceiling

Cut an  $3\frac{1}{8}$  in. (80 mm) long piece off the short pipe (NOTE: At the beveled end). Draw a line  $1\frac{1}{8}$  in. (35 mm) from the beveled end of the pipe (see fig. 8), lubricate the end with dishwashing detergent or a similar substance, push the beveled end of the pipe into the toilet then attach the T-piece to this pipe.

Place the toilet on the floor area selected for installation. Measure vertically from the center of the vertical T-pipe to the center of the spot in the roof where the pipe will be fed through. Cut a hole with a  $4\frac{5}{16}$  in. (111 mm) hole saw. Repeat the procedure through the ceiling and ensure that the pipe is properly fed through the ceiling/roof. If the outlet air pipe is to be enclosed (for example using metal siding), make sure that the end of the pipe extends at least  $15\frac{3}{4}$  in. (400 mm) above the enclosure. Make sure that the pipe is fed through the roof in compliance with building regulations. If you are unsure, contact a qualified tradesman.

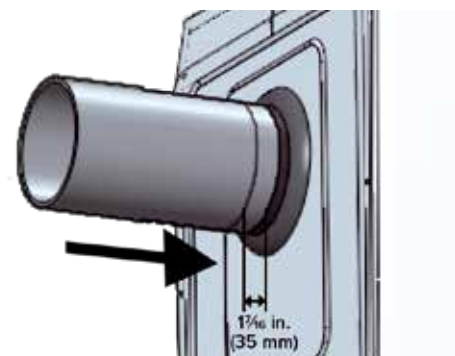

fig. 9

# Inlet Air

## Inlet Air Pipe through the Rear Wall

1. Draw a mark in the Cinderella's centerline, 6 in. (155 mm) from the floor.
2. Pre-drill a hole using a long drill bit through the interior and exterior wall in the center of where you will drill your  $4\frac{5}{16}$  in. (110 mm) hole. Make sure you are holding the drill at a  $90^\circ$  angle to the wall. Then expand the hole using a  $4\frac{3}{8}$  in. (111 mm) hole saw.
3. Install the supplied short vent pipes with the conical/beveled end towards the toilet; see fig. 10 and 11. Make a mark about  $1\frac{1}{16}$  in. (40 mm) from the end of the pipe so you know how far to push the pipe into the toilet.
4. After determining the correct length and location of the inlet air pipe, cut the pipe on the outside. NOTE: Cut the pipe flush with the exterior wall, see fig. 12. The inlet air pipe should be sealed with a suitable sealant, such as silicone, Sikaflex, etc.
5. Fit the ventilator cowl, making sure it is correctly installed. The inlet air pipe must extend about  $\frac{3}{8}$  in. (10 mm) above the lower edge and be centered. This means that the edge of the cowl must be about  $1\frac{5}{16}$  in. (34 mm) from the external surface of the pipe; see fig. 13.

Tip: Use a marker pen to mark screw holes.

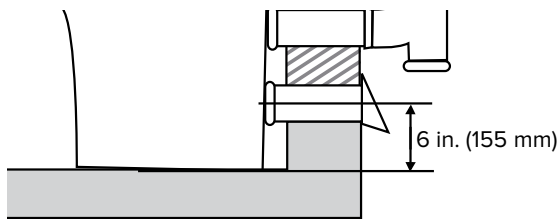

fig. 10

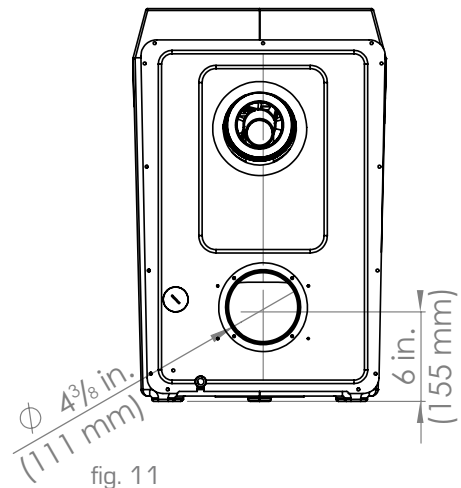

fig. 11

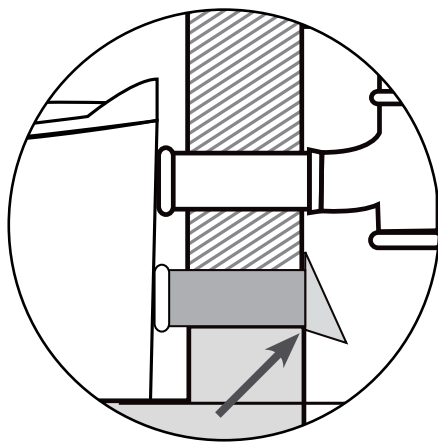

fig. 12

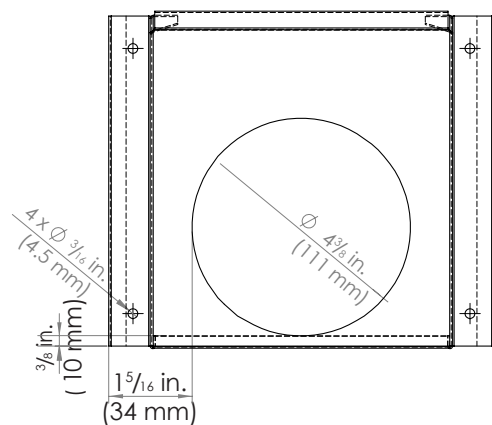
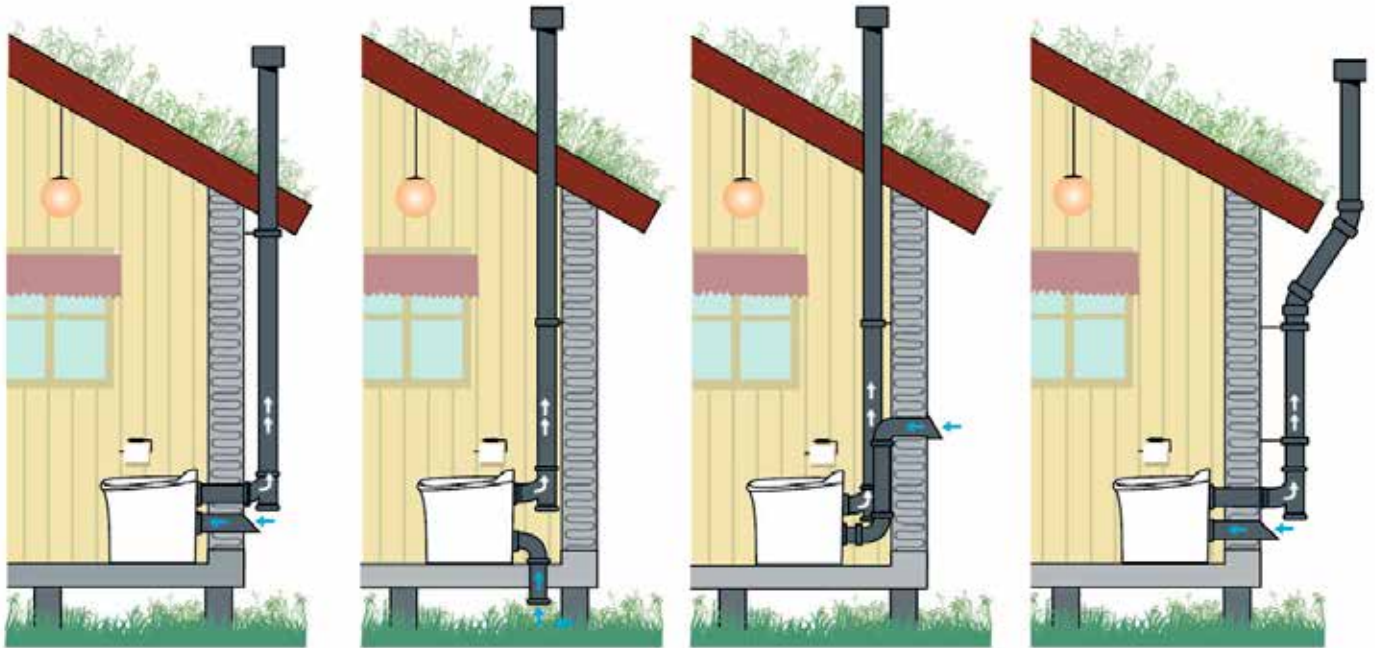

fig. 13

There are several ways to install the inlet air pipe. We have shown four examples below. See more variations at [www.cinderellaeco.com](http://www.cinderellaeco.com)  
 If you require a different design for your inlet air system, please contact your nearest sales outlet or service center.



## Inlet Air through a Wall Vent (NOT RECOMMENDED)

If you prefer not to draw in air directly to the toilet, you must make sure that there is sufficient air flow into the toilet room. The air inlet vent should be installed as close to the toilet as possible; see fig.14.

- The vent must be a properly dimensioned intake air vent with at least 6 $\frac{5}{16}$  in. (160 mm) diameter/31 square inches (201 cm<sup>2</sup>) flow area.
- The vent must be open at all times. Remember to clean the vent at regular intervals.
- It is important to ensure that there is no conflict between the requirement for air supply to the toilet and the requirements of any other installations, such as a fireplace or kitchen fan.
- The use of open windows/ doors is not a good solution because these openings will be opened and closed due to other requirements.
- Do not use a separate ventilation fan to extract air from the room where the toilet is installed.

**NOTE:** If an adjustable vent has been installed in the wall, the vent must always be open while the toilet fan is running. No obstacles (foam rubber etc.) hindering the free flow of air must be placed in the vent.

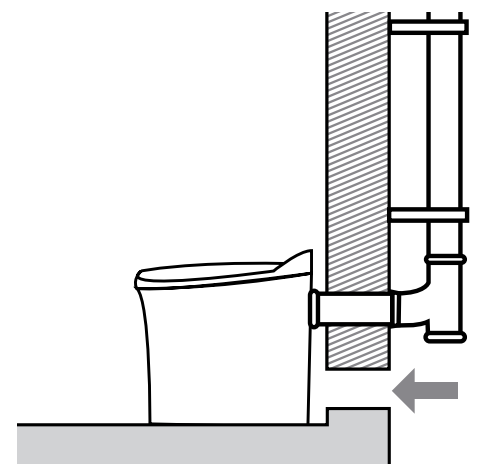

fig. 14



## Finalizing the Installation

Install the required fittings. If the outlet pipe is installed up a wall, fittings for attaching the pipe to the wall may be required.

The supplied T-piece should always be used. The plug on the T-piece must always be located at the underside since there is an exit hole for moisture on the underside of the T-piece. Because of this, the T-piece should not be enclosed, as it is necessary to inspect the exit hole to make sure it is not blocked by leaves or similar objects. In cases where T-pieces must be enclosed, an inspection hatch must be installed.

If the T-piece is installed indoors, you can place a bowl underneath to collect any moisture. Push the supplied ventilator cowl onto the pipe until it stops.

**NOTE:** Do not install a mosquito net over the end of the outlet air pipe. Cinderella may be secured to the floor using suitable fixing materials; see fig. 15.

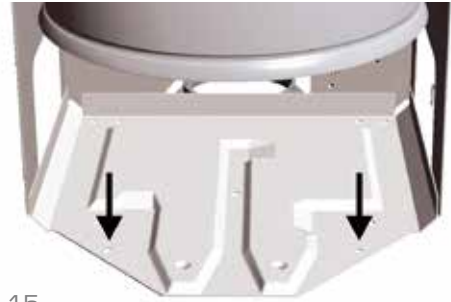

fig. 15

In order to attach the Cinderella Comfort to the floor: Remove the ash container. Drill holes through the indicated mounting holes. Use wood or machine screws as appropriate, depending on the type of floor.

## Transport safety strap

The ash container is equipped with a safety strap which must be removed before use as follows:

1. Remove the front cover.
2. Cut away the plastic straps attaching the ash container to the steel frame.
3. Remove the plastic straps.

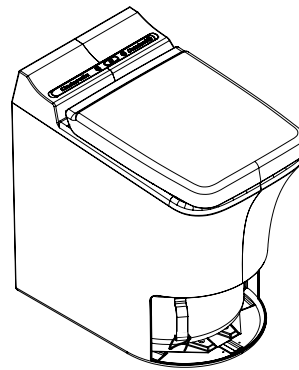

Transport safety strap

### **IMPORTANT**

Extension cords should not be used with this appliance.