

Room 3

① Galley-Kitchen 1st Floor Plan
1/2" = 1'-0"

② G- W
1/2" = 1'-0"

Angel Landings

www.angellandings.com

Tel# 917-653-0551

Galley Kitchen

11000

2/5/2021

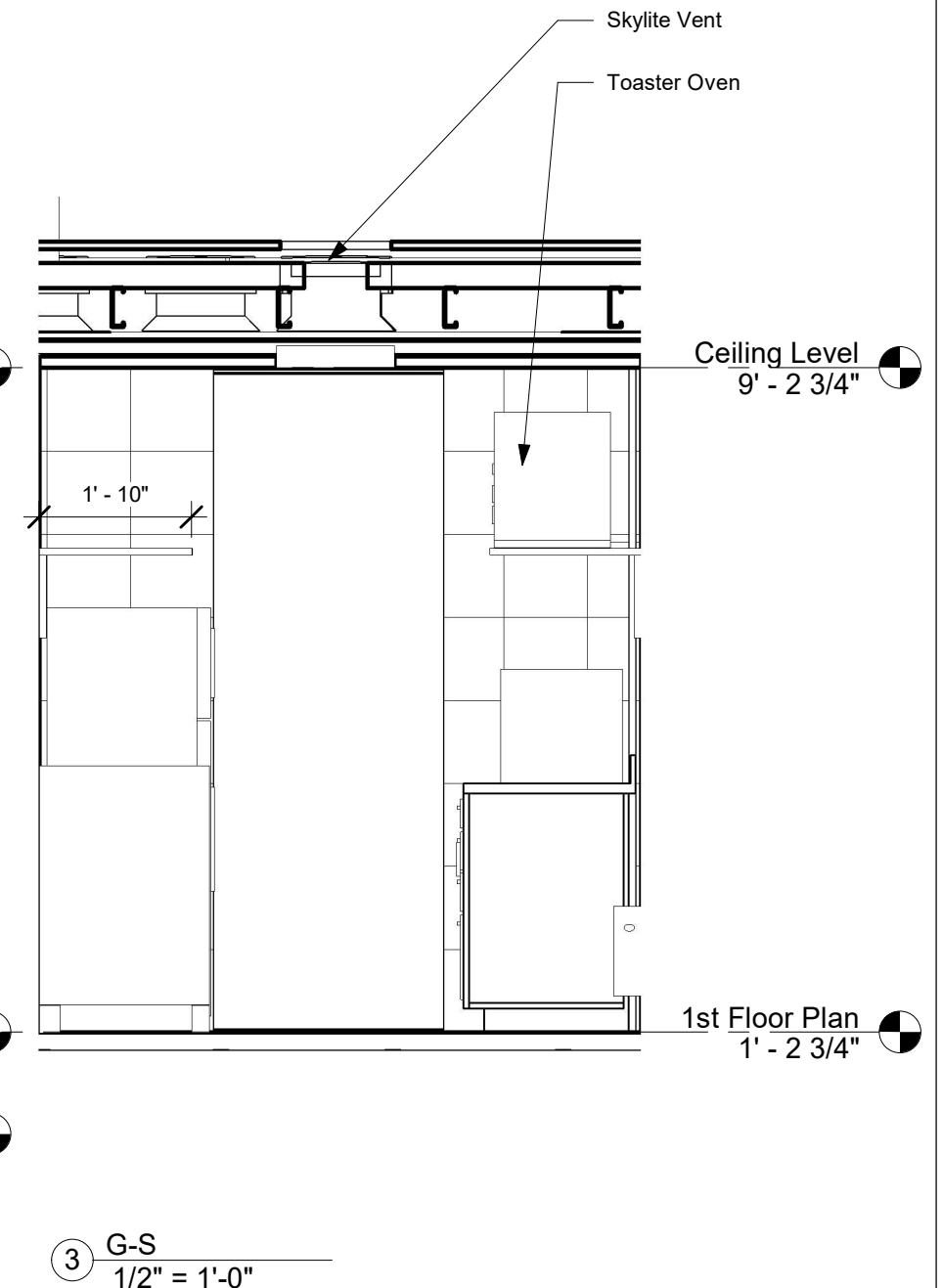
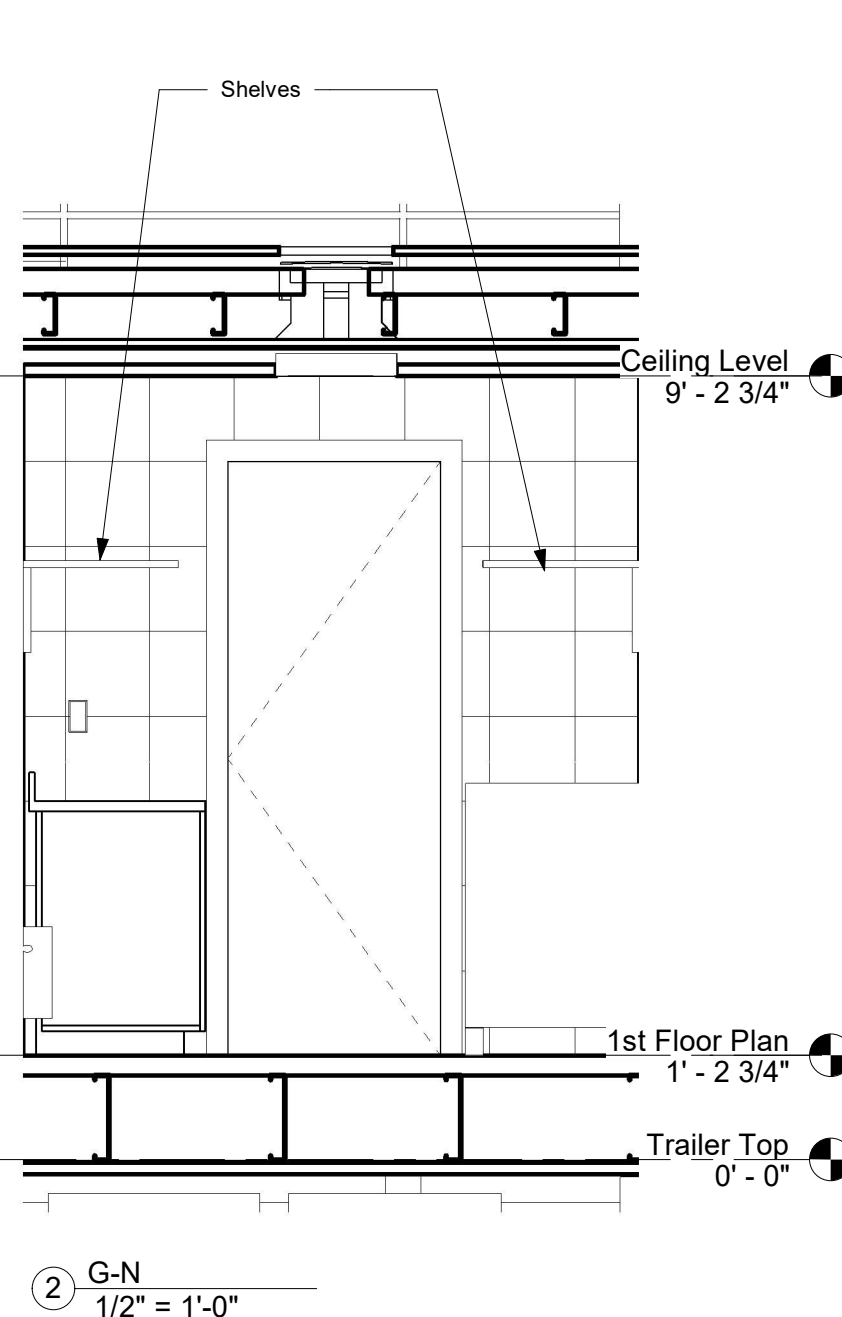
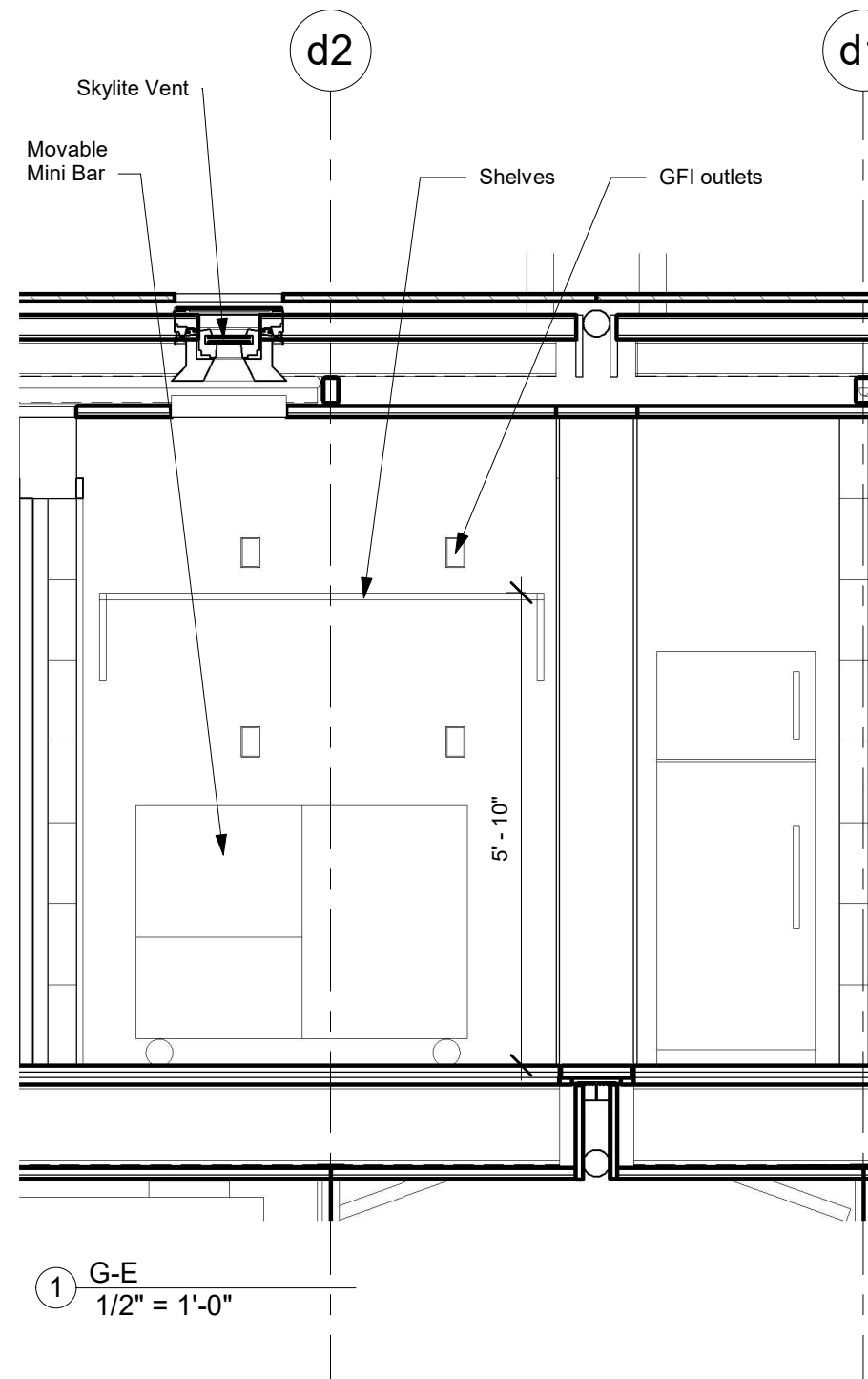

Angel Landings

www.angellandings.com

Tel# 917-653-0551

Galley Kitchen- Elevations

11001

2/5/2021

Deliver to jag
New York 10002

Home & Kitchen ▾

Hello, SP...
Account ▾

Returns
& Orders

0

All

Buy Again

Browsing History ▾

Shopper Toolkit

Kindle Books

TV & Video

Gift Cards

Handmade

Low prices for fun outdoors

Amazon Home

Shop by Room

Discover

Shop by Style

Home Décor

Furniture

Kitchen & Dining

Bed & Bath

Garden & Outdoor

Home Improvement

amazonpharmacy

Your medication, delivered

Learn more >



Home & Kitchen › Kitchen & Dining › Small Appliances › Countertop Burners

NutriChef Double Induction Cooktop 120V Portable Digital Ceramic Dual Burner w/Kids Safety Lock-Works with Flat Cast Iron Pan,1800 Watt,Touch Sensor, 12 Controls PKSTIND48

Visit the NutriChef Store
1,296 ratings
Amazon's Choice in Countertop Bur...

Price: \$173.99 & FREE Returns

Pay \$29.00/month for 6 months (plus S&H, tax) with 0% interest equal monthly payments when you're approved for an Amazon Prime Store Card.

May be available at a lower price from other sellers, potentially without free Prime shipping.

Style: Double

A Single \$54.99	Double \$173.99
---------------------	--------------------

Brand	NutriChef
Material	Glass, Ceramic
Color	Black
Item	14.18 x 23.63 x 2.64
Dimensions	inches
LxWxH	
Item	12.35 Pounds

See more

About this item

- TWO HEATING ZONES: This Professional Digital Countertop Dual Induction Cooker by NutriChef is equipped with 2 Circular Top Panel Heating Zones with Independent Configurable Temperature Zone

Buy new: \$173.99 & FREE Returns

FREE delivery: Friday, April 23
Order within 6 hrs and 40 mins Details

Deliver to jag - New York 10002

In Stock.

Qty: 1

Add to Cart

Buy Now

Secure transaction
Ships from Amazon.com
Sold by Amazon.com
Packaging Shows what's inside

Details
Return policy: This item is returnable
Support: Free Amazon tech support included

- Add a Protection Plan:
- ☐ 4-Year Protection for \$29.99
 - ☐ 3-Year Protection for \$21.99
 - ☐ Add a gift receipt for easy returns

Save with Used - Very Good \$135.14
FREE delivery: Tuesday, April 27
Ships from: Amazon
Sold by: Amazon Warehouse

Add to List

Add to Registry & Gifting



From the manufacturer



5 WASHING PROGRAMS

FULL SIZE DISHWASHER CLEANING IN A COUNTERTOP SIZED UNIT!



NORMAL, RAPID & GLASS



FRUIT WASH



BABY CARE



DISHWASHER INCLUDES A
**5-LITER BUILT-IN
WATER TANK**
SO YOU DON'T NEED
A WATER HOOKUP!

WATER HOSE IS INCLUDED FOR A DIRECT
WATER HOOKUP TO ANY FAUCET
(ADAPTER NOT INCLUDED)

WATER HOSE IS INCLUDED
TO HOOK DISHWASHER UP
TO YOUR KITCHEN FAUCET



YOU MAY NEED AN **ADAPTER**
(NOT INCLUDED) FOR THE
HOSE TO FIT YOUR FAUCET



THE **L SHAPE** END CONNECTS
TO DISHWASHER & THE
STRAIGHT END CONNECTS
TO FAUCET



Compare with similar items

rom the manufacturer



the Smart Oven® Air
Super Convection,
Super Versatile



Breville®

Kitchen appliances designed to inspire people to produce perfect food and beverage results in their own homes with ease. From espresso machines to food processors, the innovation in each appliance delights. Breville makes the process a pleasure and the end result perfect, every time.

The Smart Oven Air by Breville, BOV900BSSUSC

13 smart cooking functions with air fry and dehydrate.

Product DNA



Super Convection Technology

The Smart Oven Air's 2-speed convection fan (Super and Regular) offers greater cooking control. Super convection provides a greater volume of air to ensure fast and even heat distribution, perfect for air frying, dehydration and roasting.

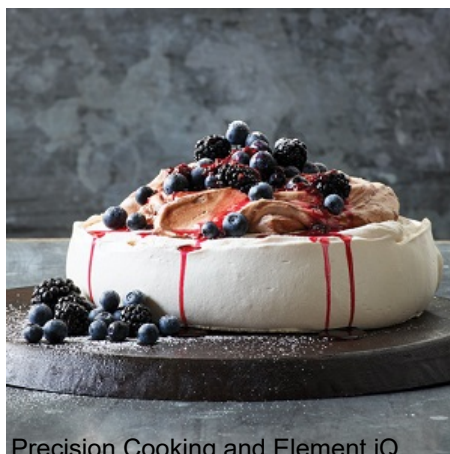

Precision Cooking and Element iQ

We've taken the benefits of Element iQ one step further by adding Breville sensing and PID temperature control technology. With Element iQ - 6 independent quartz heating elements move the power where it's needed most, above and below the food for perfect results.



Air Fry and Dehydrate Presets

Why buy a stand alone air fryer or dehydrator when the Smart Oven Air can air fry french fries and other family favorites and dehydrate a range of foods. Dehydrate up to 4 trays of goodness.

Product DNA



Size Matters

The large, 1 cubic ft, interior makes room for toasting 9 slices of bread, roasting a 14-lb turkey, air fry favorites like French fries, slow cook with a 5-qt Dutch oven and comfortably fit most 9" x 13" pans and 12 cup muffin trays.



Super Versatile

13 cooking functions to guide you to perfection: Toast 9 slices, Bagel, Broil, Bake, Roast, Warm, Pizza, Proof, Air Fry, Reheat, Cookies, Slow Cook, Dehydrate.



LCD Display

The Smart Oven Air comes with a LCD Display to more easily access the built in smart functionality. Integrated oven light automatically turns on at the end of cooking cycle or can be switched at the touch of a button.

[Food & Beverage](#) / [Mobile Cooking](#) / [RV & Boat Sinks](#)

Dometic VA8000 Series Sink

Square Stainless Steel Sink with Faucet Hole

★★★★★ (0)

This stylish square inset sink with heat-resistant safety glass lid provides the perfect home-from-home kitchen solution.



\$342.67

Art nr: 9102303252

Feedback

Features



Specifications



General **Dimensions** Additional

Dimensions product depth, ["]
14.57

Dimensions product height, ["]
5.77

Dimensions product width, ["]
16.54

Net weight, [lbs]
6.62

Reviews



WARNING This product can expose you to chemicals including arsenic, which is known to the State of California to cause cancer. For more information, go to www.P65Warnings.ca.gov.



Feedback

Support Form **Dometic VA 930**



Square sink, 280 x 380 mm

This neat square inset sink, made of stainless steel, is compact, tough and easy to clean.

Show this product's article number

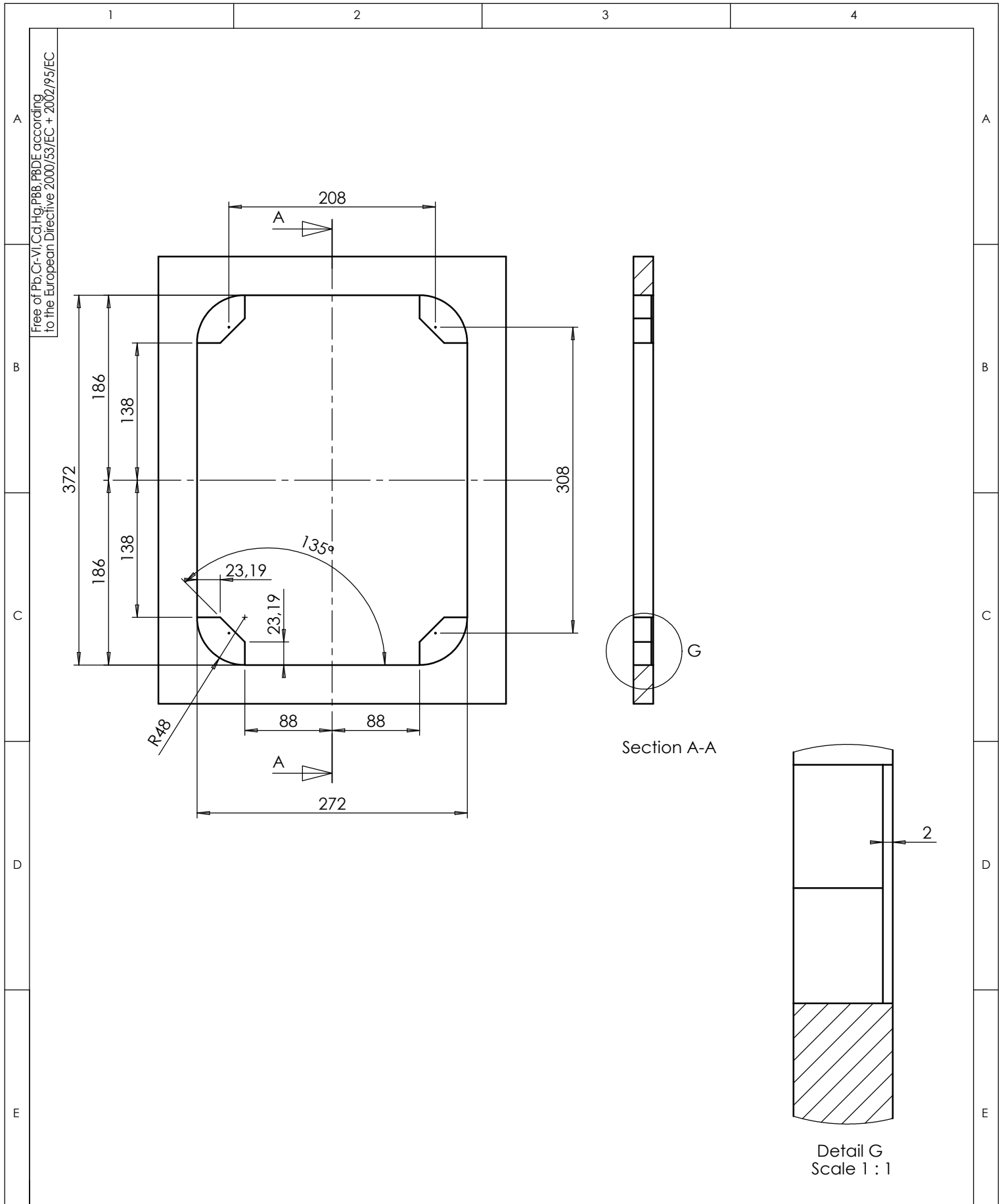
Visit product page



Dimensions without tolerance indication (UNI EN 22768-1:1996) Fine precision		Pos.		Title		N° pcs	Dwg N°	Part No.	Weight	Material	Finish / Standard		
		Rev.Date		Rev.Title						Requested		Effective	Approved
Range	mm	Title:				Material:			Cycle No:				
0 - 6	±0.05	Cut out VA093000FV00				Weight			Tooling code:				
6 - 30	±0.1			Notes:			Date: 14/03/14						
30 - 120	±0.15						Drawing by: C. Toffanin						
120 - 315	±0.2						Approved by:						
315 - 1000	±0.3			This drawing is COPYRIGHT and the property of SMEV Srl. It must not be copied (in whole or in part), used, or in any way disclosed without prior consent of SMEV Srl.		 by Dometic GROUP		Part No.:			Drawing Nr.: Z1140		
1000-2000	±0.5												
2000-4000	-												
Angles	±1												
Radiuses	±1												
1		2		3		4							

DOMETIC

REFRIGERATION

REFRIGERATOR

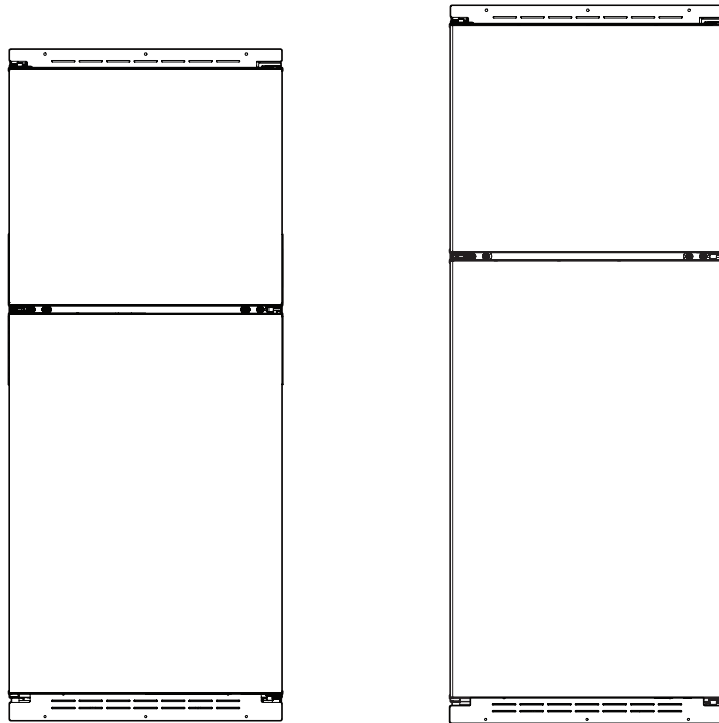

DMC4101 & DMC4081

EN

DMC Refrigerators

Installation and Operation Manual2

FR

Réfrigérateurs DMC

Manuel d'installation et d'utilisation18

WARNING

Cancer and Reproductive Harm
www.P65Warnings.ca.gov



Service Center & Dealer Locations

Visit: www.dometic.com

Read these instructions carefully. These instructions **MUST** stay with this product.

Contents

1 Explanation of Symbols and Safety Instructions	2
1.1 Recognize Safety Information	2
1.2 Understand Signal Words	2
1.3 Supplemental Directives	3
1.4 General Safety Messages	3
2 General Information	3
2.1 Component Descriptions	4
3 Intended Use	4
4 Specifications	4
5 Installation	5
5.1 Removing the Existing Refrigerator	5
5.2 Preparing for Installation	5
5.3 Positioning the Refrigerator	6
5.4 Securing the Refrigerator	6
5.5 Making the Electrical Connections	7
6 Door Swing Reversal	8
6.1 Removing the Upper Hinge	8
6.2 Removing the Middle Hinge	9
6.3 Removing the Lower Hinge	9
6.4 Reinstalling the Lower Hinge Pin	10
6.5 Removing the Handles	10
6.6 Reinstalling the Handles	11
6.7 Changing the Door Stop Bushing	11
6.8 Reinstalling the Fresh Food Door, Lock, and Middle Hinge	12
6.9 Reinstalling the Upper Hinge	12

7 Operation	13
7.1 Storing Refrigerated Goods	13
7.2 Using the Control Panel	13
7.3 Adjusting the Shelves	14
8 Care and Maintenance	14
8.1 Defrosting the Refrigerator	15
8.2 Cleaning the Refrigerator	15
8.3 Storing the Refrigerator	15
9 Troubleshooting	15
10 Disposal	17
LIMITED ONE-YEAR WARRANTY	17

1 Explanation of Symbols and Safety Instructions

This manual has safety information and instructions to help you eliminate or reduce the risk of accidents and injuries.

1.1 Recognize Safety Information

 **This is the safety alert symbol.** It is used to alert you to potential physical injury hazards. Obey all safety messages that follow this symbol to avoid possible injury or death.

1.2 Understand Signal Words

A signal word will identify safety messages and property damage messages, and also will indicate the degree or level of hazard seriousness.

DANGER!

Indicates a hazardous situation that, if **not** avoided, will result in death or serious injury.

WARNING

Indicates a hazardous situation that, if **not** avoided, could result in death or serious injury.

CAUTION

Indicates a hazardous situation that, if **not** avoided, could result in minor or moderate injury.

NOTICE: Used to address practices **not** related to physical injury.

 Indicates additional information that is **not** related to physical injury.

1.3 Supplemental Directives

To reduce the risk of accidents and injuries, please observe the following directives before proceeding to install, operate, or service this appliance:

- Read and follow all safety information and instructions.
- Read and understand these instructions before installing, operating, or servicing this product.
- The installation **must** comply with all applicable local or national codes, including the latest edition of the following standards:

U.S.A.

- ANSI/NFPA70, National Electrical Code (NEC)
- ANSI/NFPA 1192, Recreational Vehicles Code

Canada

- CSA C22.1, Parts I & II, Canadian Electrical Code
- CSA Z240 RV Series, Recreational Vehicles

1.4 General Safety Messages

 **WARNING: ELECTRICAL SHOCK, FIRE, AND/OR EXPLOSION HAZARD. Failure to obey the following warnings could result in death or serious injury:**

- Use only Dometic replacement parts and components that are specifically approved for use with the appliance.
- Avoid improper installation, adjustment, alterations, service, or maintenance of the appliance. Service and maintenance **must** be done by a qualified service person only.
- Do **not** modify this product in any way. Modification can be extremely hazardous.

- Do **not** store or use gasoline or other flammable vapors and liquids in the vicinity of this or any other appliance.
- Do **not** leave the refrigerator in extreme cold or warm temperatures.
- Do **not** allow the appliance to be exposed to rain.
- This refrigerator **must** be grounded. Consult a qualified electrician or service person if the grounding instructions are **not** completely understood or if doubt exists as to whether the appliance is properly grounded. In the event of an electrical short circuit, grounding reduces the risk of electric shock by providing an escape wire for the electric current.
- Do **not** damage the refrigerant circuit when handling, moving, or using the refrigerator.

WARNING: HEALTH HAZARD.

This refrigerator is **not** intended for the proper storage of medicine. It is only suitable for cooling and storing foodstuffs. Failure to obey this warning could result in death or serious injury.

WARNING: TIPPING HAZARD. Failure to obey the following warnings could result in death or serious injury:

- Do **not** allow children to climb, stand on, or hang on the refrigerator.
- Do **not** allow a long cord to drape over the counter top or table top where it can be pulled on by children or tripped over unintentionally. Failure to obey this warning could result in death or serious injury.

2 General Information

This section provides reference information regarding the recommended tools for installation.

 The images used in this document are for reference purposes only. Components and component locations may vary according to specific product models. Measurements may vary ± 0.38 in. (10 mm).

Dometic recommends that you have the following tools on-hand during installation, which are required for door adjustments and installation.

Recommended Tools	
Phillips Screwdriver	10 Mm Socket Wrench
Flathead Screwdriver	Level
Pliers	T15 Torx Driver/Bit
Putty Knife	

2.1 Component Descriptions

Figure 1 provides information about the internal components of the refrigerator.

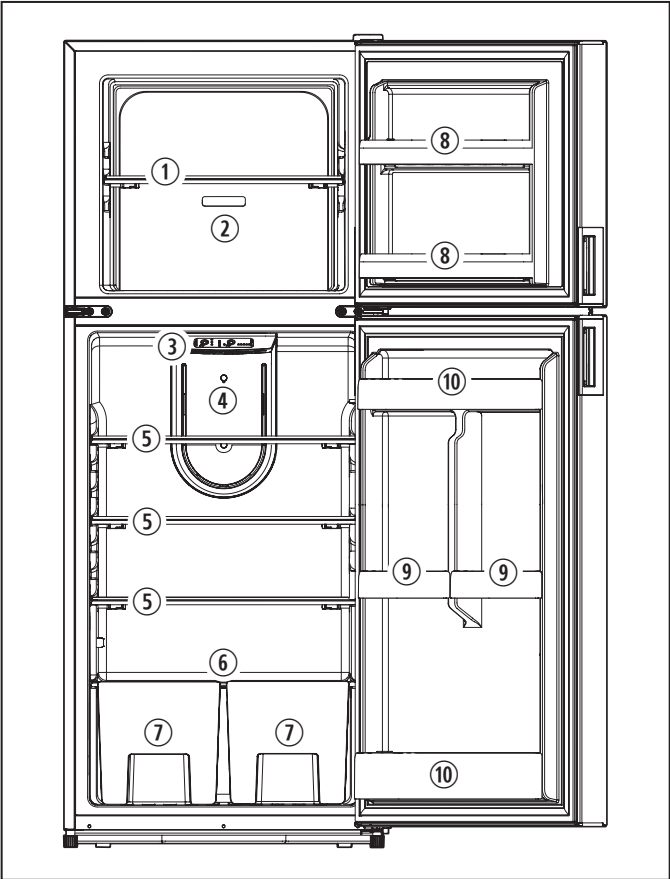

1 Internal Component Locations

- ① Freezer Shelf

② Freezer Temperature Control

③ Adjustable Temperature Control

④ LED Light

⑤ Glass Shelf¹
- ⑥ Clear Glass Crisper Cover

⑦ Clear Crisper

⑧ Full-Width Freezer Shelf

⑨ Small Door Shelf

⑩ Full-Width Door Shelf

¹Note: DMC4101 quantity 3; DMC4081 quantity 2

3 Intended Use

The DMC refrigerators are designed and intended for use only inside the recreational vehicle (hereinafter referred to as “RV”) for which they are supplied. Use these instructions to ensure correct operation of the refrigerators.

i These refrigerators are only suitable for cooling and storing foodstuffs. The refrigerators are **not** intended for the proper storage of medicine.

The manufacturer accepts no liability for damage in the following cases:

- Faulty assembly or connection
- Damage to the product resulting from mechanical influences and excess voltage
- Alterations to the product without express permission from the manufacturer
- Use for purposes other than those described in the operating manual

Dometic Corporation reserves the right to modify appearances and specifications without notice.

4 Specifications

The following table provides the exterior dimensions and power specifications for the refrigerators.

DMC4101 Dimensions (H x W x D)	59.6 in. (1514.0 mm) x 23.6 in. (600.0 mm) x 27.5 in. (698.0 mm)
DMC4081 Dimensions (H x W x D)	53.6 in. (1360.0 mm) x 23.6 in. (600.0 mm) x 27.5 in. (698.0 mm)
Voltage Range²	10.5 VDC–17.0 VDC
Power Supply Requirements	10.5 VDC–17.0 VDC, ≥15 A

² Note: The compressor will stop running when the voltage is lower than 10.5V. Direct connection with an AC power source is forbidden.

The following table provides the recommended electrical wiring lengths for the refrigerators.

Wire Size	Maximum Length	Wire Size	Maximum Length
13 AWG ³	8.0 ft (2.4 m)	8 AWG	33.0 ft (10 m)
12 AWG	13.0 ft (4.0 m)	6 AWG	50.0 ft (15.2 m)
10 AWG	20.0 ft (6.1 m)		

³ Note: 14 AWG wire is not recommended. 13 AWG or larger is recommended. The DC refrigerators are not equipped with a power source. A power source is available at your authorized Dometic Dealer.

5 Installation

⚠ WARNING: ELECTRICAL SHOCK, FIRE, AND/OR EXPLOSION HAZARD. Failure to obey the following warnings could result in death or serious injury:

- Do **not** install the refrigerator where there is excessive moisture or where water can splash onto the appliance.
- Do **not** install the refrigerator in a location where the ventilation openings in the appliance enclosure or in the built-in structure might become obstructed.
- Do **not** install the refrigerator near heat sources or open flames.

⚠ WARNING: TIPPING HAZARD.

Do **not** allow a long cord to drape over the counter top or table top where it can be pulled on by children or tripped over unintentionally. Failure to obey this warning could result in death or serious injury.

NOTICE: Do **not** place heavy items on top of the refrigerator. Failure to obey this notice can result in damage to the refrigerator.

This section describes how to install the refrigerator.

5.1 Removing the Existing Refrigerator

i If a refrigerator is not already present, skip to section "Preparing for Installation" on page 5.

1. Disconnect the 120 VAC power cord from the receptacle at the rear of the refrigerator enclosure, if applicable.
2. Disconnect the 12 VDC leads from the refrigerator and cap the lead ends, if applicable.
3. Turn off the LP gas supply to the refrigerator, if applicable.
4. Disconnect the LP gas line from the refrigerator.
5. Cap the line and verify there are no LP gas leaks.
6. Remove the mounting screws anchoring the refrigerator to the enclosure.
7. Slide the refrigerator from the enclosure and remove it from the RV.

5.2 Preparing for Installation

Verify the enclosure meets the following requirements before installation:

1. Utility hookups are present and comply with all applicable codes.
2. Holes do not exist inside the enclosure, except ventilation holes.
3. Objects do not protrude into the enclosure, except utility connections for the refrigerator.
4. The enclosure must be free of materials that may damage the refrigerator.
5. The floor must be level and able to support the weight of the refrigerator and its contents.
6. The refrigerator must be level and installed in a sturdy enclosure.
7. A wood strip must be placed above the upper opening and below the lower opening of the enclosure. The top and bottom refrigerator mounting brackets are anchored to the wood strips with screws.
8. The refrigerator must not be installed directly on carpeting.
9. Adjacent heat sources must not affect the ventilation of the refrigerator.

5.3 Positioning the Refrigerator

NOTICE: If the refrigerator is **not** leveled during installation, the doors may **not** close or seal properly, causing cooling, frost, or moisture problems. It is very important for the refrigerator to be level in order to function properly.

This section describes proper positioning for the refrigerator before installation.

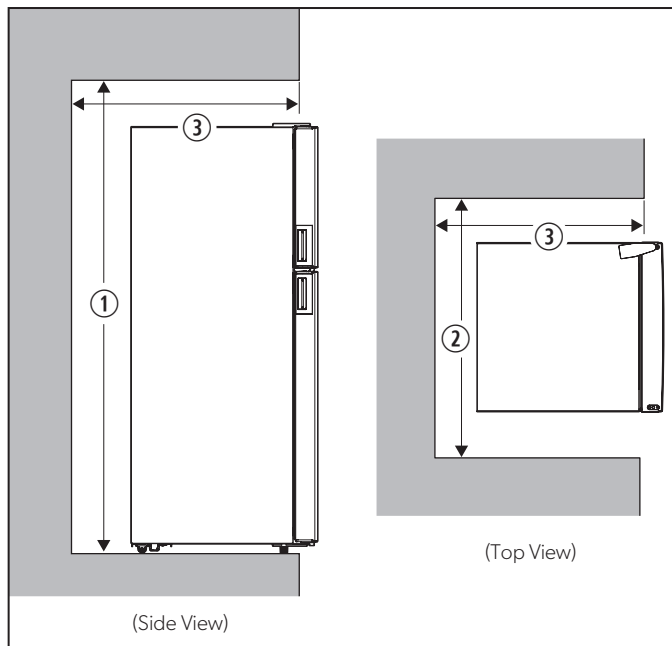

2 Enclosure Dimensions

- ① DMC4101 59.9 in. (1523.0 mm)
DMC4081 53.9 in. (1369.0 mm)
Enclosure Height

- ② 24.0 in. (610.0 mm) Enclosure Width

- ③ 24.0 in. (610.0 mm) Enclosure Depth

1. Position the refrigerator away from heat sources such as stoves, radiators, and direct sunlight.
2. Place the refrigerator in a stable, flat location.
3. Level the refrigerator by turning the leveling legs clockwise (to raise the refrigerator) or counter-clockwise (to lower the refrigerator).
4. Leave the refrigerator in an upright position for at least four hours before turning it on.

5.4 Securing the Refrigerator

This section describes how to secure the refrigerator in the enclosure.

- ① If the door swing will be reversed, complete the reversal procedure before securing the refrigerator inside the enclosure. Refer to "Door Swing Reversal" on page 8 for details.
- ① Before securing the refrigerator, ensure the refrigerator is positioned correctly. Refer to "Positioning the Refrigerator" on page 6 for details.

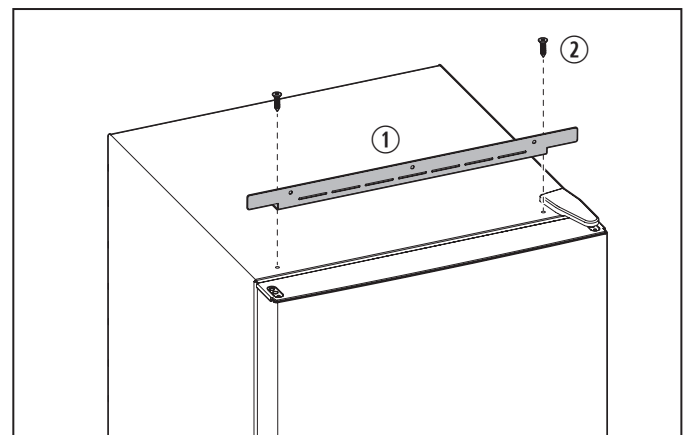

3 Installing the Top Mounting Bracket

- ① Top Mounting Bracket ② Mounting Screw

1. Secure the top mounting bracket to the refrigerator using the two M5 x 20 mounting screws provided.
2. Place the refrigerator completely into the enclosure.

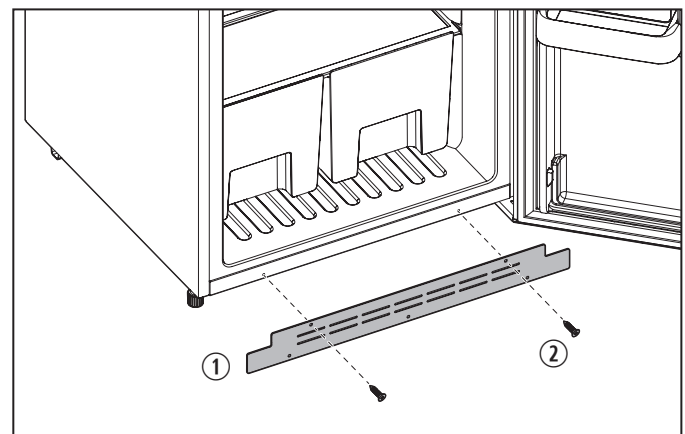

4 Installing the Bottom Mounting Bracket

- ① Bottom Mounting Bracket ② Mounting Screw

- Opening the fresh food door, secure the bottom mounting bracket to the refrigerator using the screws provided.

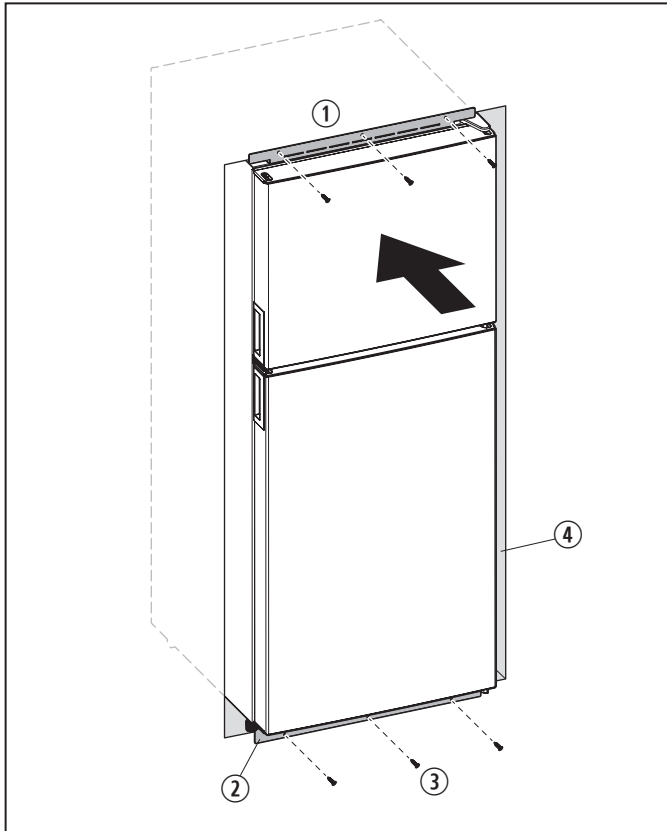

5 Securing the Refrigerator to the Enclosure

- ① Top Mounting Bracket ③ Mounting Screw
② Bottom Mounting Bracket ④ Enclosure

- Secure the refrigerator within the enclosure using the six self-tapping screws that will go through the top and bottom mounting brackets.

5.5 Making the Electrical Connections

⚠ WARNING: ELECTRICAL HAZARD. Failure to obey these warnings could result in death or serious injury.

- Before wiring the refrigerator, turn off and disconnect the refrigerator from the main power supply.
- Before making the electrical connection to the refrigerator, ensure that you read and understand the grounding-related warning provided on page 3.

- i** For wire length specifications, refer to "Specifications" on page 4.

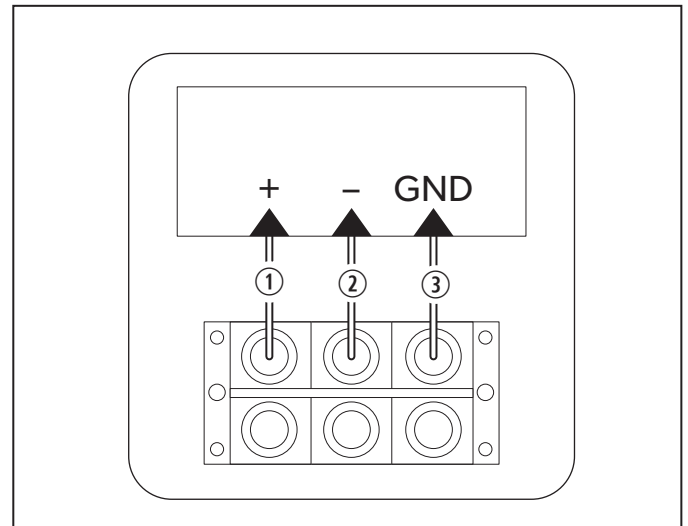

6 Connecting the Wires

- Ensure the voltage and frequency indicated on the data plate correspond to those of the electrical mains. This refrigerator requires a 10.5–17.0 VDC \geq 15 A power supply.
- Connect the "+" terminal to the positive 12 VDC wire.
- Connect the "-" terminal to the negative 12 VDC wire.
- Connect the "GND" wire to the converter ground or bus ground.
- Reconnect and turn on the refrigerator.
- Wait three to five minutes before restarting the refrigerator as it might fail to operate properly if restarted too quickly.

6 Door Swing Reversal

⚠ CAUTION: TIPPING HAZARD.

Take care when tilting the refrigerator backwards. Failure to obey this caution could result in minor or moderate injury.

NOTICE: It is necessary to tilt the refrigerator backwards to take the bottom hinge off. Rest the refrigerator against something solid, just below the top panel. Do **not** lay the appliance completely flat, as this may damage the coolant system.

NOTICE: If the location requires removing the refrigerator from the enclosure, be sure the wiring and the power cord are long enough, or disconnect the wiring and power cord before moving. Failure to do so could damage the wiring connections.

This section describes the process to change the direction in which the door opens.

Dometic recommends that you obtain assistance before completing the door reversal process.

Before beginning the door reversal process:

1. Remove any refrigerator contents.
2. Turn the breaker off or unplug the 12 VDC power to the appliance.
3. Remove the three screws at the top and the three screws at the bottom of the refrigerator that secure the mounting brackets to the cabinet.

6.1 Removing the Upper Hinge

This section describes removing the freezer door and upper hinge bracket.

i Keep all the hardware and screws for reinstallation.

1. Slide the refrigerator out several inches from the enclosure to access the upper hinge bracket.

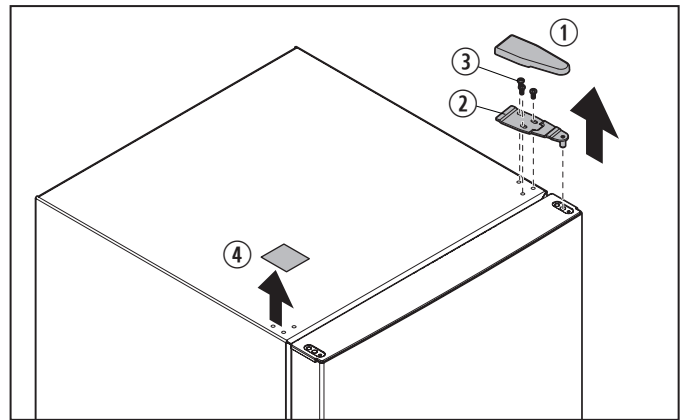

7 Removing the Upper Hinge Bracket

- | | |
|-----------------------|-----------------------|
| ① Upper Hinge Cover | ③ Hinge Screws |
| ② Upper Hinge Bracket | ④ Plastic Screw Cover |

2. In a front to back motion, pop the upper hinge cover off the upper hinge bracket.
3. Use a 10 mm socket wrench to remove the three screws that secure the upper hinge bracket to the refrigerator, and then remove the bracket.
4. Gently use a putty knife to pry up the reusable plastic screw cover from the opposite side where the upper hinge bracket will be installed. Reserve the cover for use later.

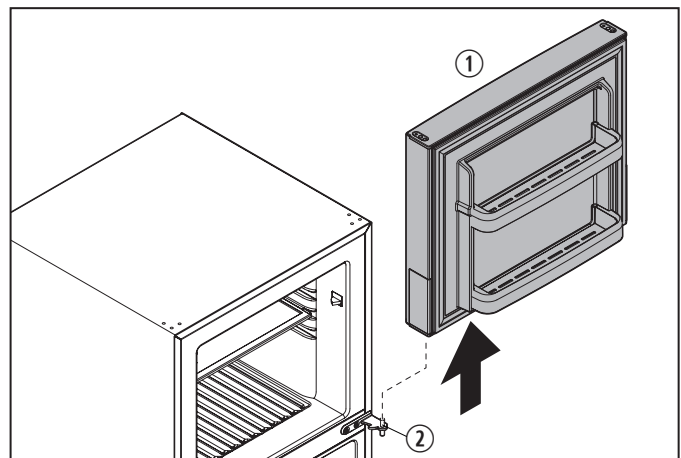

8 Removing the Freezer Door

- | | |
|----------------|------------------------|
| ① Freezer Door | ② Middle Hinge Bracket |
|----------------|------------------------|

5. Depress the freezer door handle. Gently pull the door upward off the middle hinge to release the magnetic seal and remove the door.
6. Lay the door on a soft surface, finish side down.

6.2 Removing the Middle Hinge

This section describes removing the fresh food door, middle hinge bracket, and lock assembly.

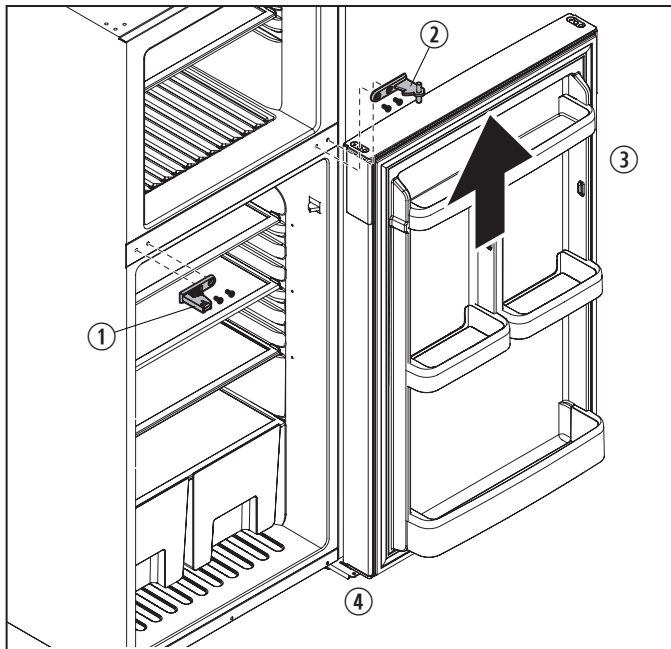

9 Removing the Middle Hinge Bracket, Lock Assembly, and Door

- ① Lock Assembly ③ Fresh Food Door
- ② Middle Hinge Bracket ④ Lower Hinge Bracket

i Keep all the hardware and screws for reinstallation.

1. At the top of the fresh food door, use a Phillips screwdriver to remove the two screws that secure the lock assembly, and the two screws that secure the middle hinge bracket.
2. Pull up on the hinge to remove it from the door.
3. Depress the door handle. Gently pull the door upward off the lower hinge to release the magnetic seal and remove the door.
4. Lay the door on a soft surface, finish side down.

6.3 Removing the Lower Hinge

This section describes removing the lower hinge bracket and leveling feet.

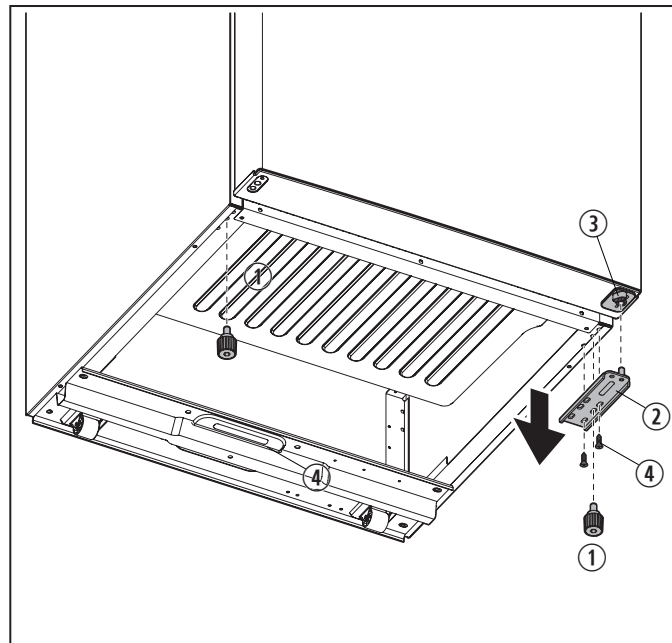

10 Removing the Lower Hinge Bracket and Leveling Feet

- ① Hinge-Side Leveling Foot ③ Door Stop Bushing
- ② Lower Hinge Bracket ④ Mounting Screws

i Keep all the hardware and screws for reinstallation.

1. With the refrigerator tilted back slightly to access the bottom, remove the front leveling feet by turning them counter-clockwise until they fully disengage.
 2. Use a 10 mm socket wrench to remove all the screws securing the lower hinge to the door stop bushing.
- i** Keep the hinge-side leveling foot with the lower hinge bracket.

6.4 Reinstalling the Lower Hinge Pin

This section describes reinstalling the lower hinge bracket.

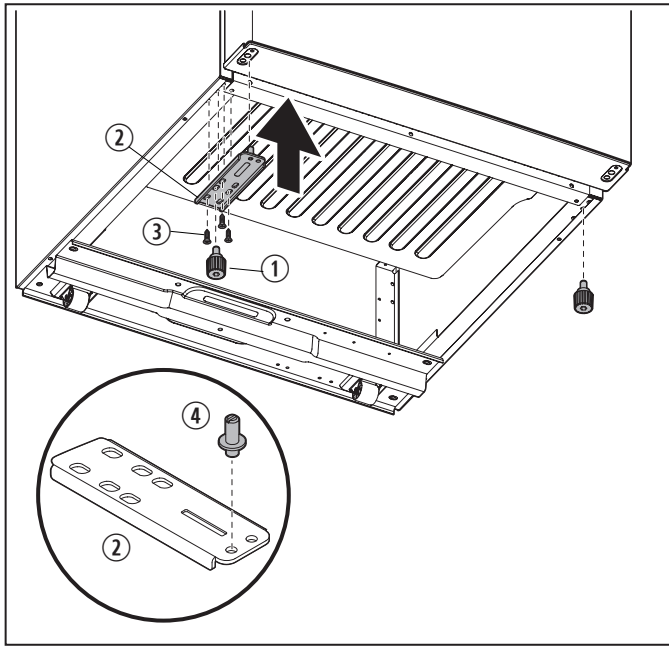

11 Reinstalling the Lower Hinge Bracket and Hinge Pin

- ① Hinge-Side Leveling Foot ③ Mounting Screws
② Lower Hinge Bracket ④ Hinge Pin

i Keep all the hardware and screws for reinstallation.

1. On the lower hinge bracket, use a flathead screwdriver to remove the hinge pin. Place the hinge pin into its new bracket slot, immediately next to its original position.
- i** The hinge pin must change slots to remain in an outer edge position after swapping swing sides.
2. Holding the lower hinge bracket in its new location, use the hinge-side leveling foot to hold the hinge bracket loosely to the bottom of the refrigerator. Turn the foot clockwise until secure.
3. Install the mounting screws, using the outer edge top and lower slots, and the inner middle slot. Tighten securely.
4. Install the remaining leveling foot on the opposite side of the refrigerator.

6.5 Removing the Handles

This section describes removing the handles and decor well covers.

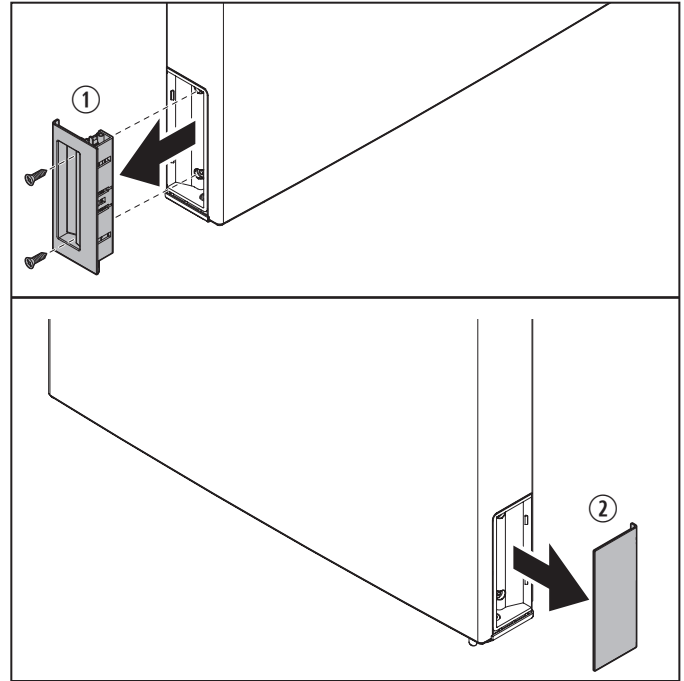

12 Removing the Handles and Decor Well Covers

- ① Door Handle ② Decor Well Cover

i Keep all the hardware and screws for reinstallation.

1. Depress the freezer door handle latch to remove the two Phillips head screws that secure the handle.
2. While using a screwdriver to push in the handle's plunger pin completely and depressing the handle latch, lift the handle out of the handle well.
3. On the opposite edge of the door, pop off the freezer decor well cover.
4. Snap the decor well cover onto the original handle well location. Align the cover under the edge of the door cap.
5. Repeat steps 1 through 4 for the fresh food door.

i At reinstallation, the freezer handle will rotate 180° to become the fresh food handle. The fresh food handle will rotate 180° to become the freezer door handle.

6.6 Reinstalling the Handles

This section describes swapping and reinstalling the handles.

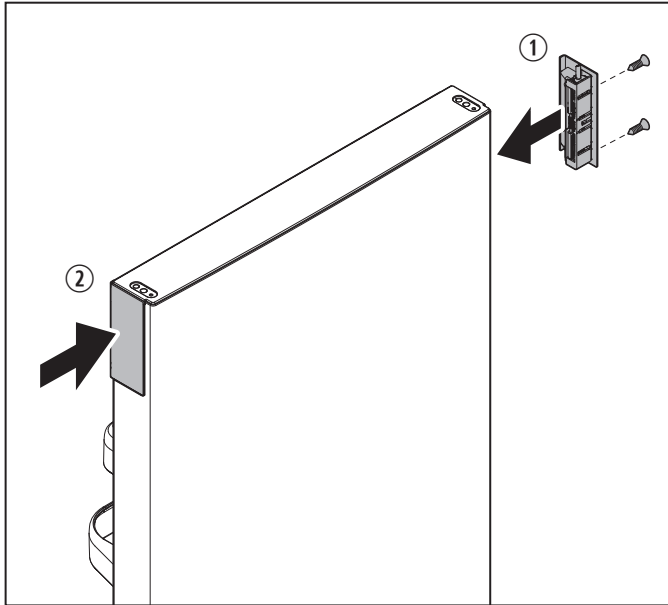

13 Reinstalling the Handles and Decor Well Covers

① Door Handle ② Decor Well Cover

1. Rotate the original freezer handle 180°.
 2. While using a screwdriver to push in the handle's plunger pin in completely and depressing the handle latch, place the handle into the fresh food door handle well.
- i** Be sure the handle's plunger pin is inserted in the former hinge hole.
3. Depress the handle latch to reinstall the two Phillips head screws to secure the handle.
 4. Repeat steps 1 through 3 to secure the original fresh food door handle to the freezer door.

6.7 Changing the Door Stop Bushing

This section describes removing and replacing the door stop bushing.

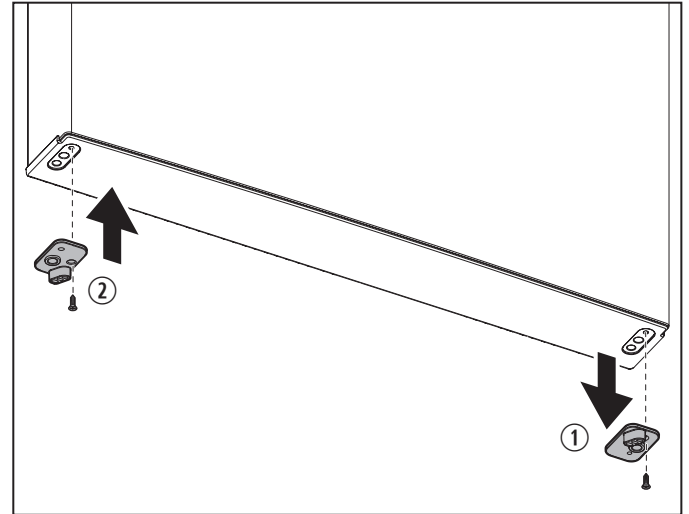

14 Reinstalling the Bushing

① Door Stop Bushing ② New Door Stop Bushing

1. Remove the door stop bushing from the bottom of the fresh food door.
 2. Use a Torx driver to install the new replacement door stop bushing and new screws on the opposite side of the fresh food door.
 3. Repeat steps 1 and 2 for the freezer door.
- i** The new door stop bushing should not hang over the door edge.

6.8 Reinstalling the Fresh Food Door, Lock, and Middle Hinge

This section describes reinstalling the fresh food door and middle hinge bracket.

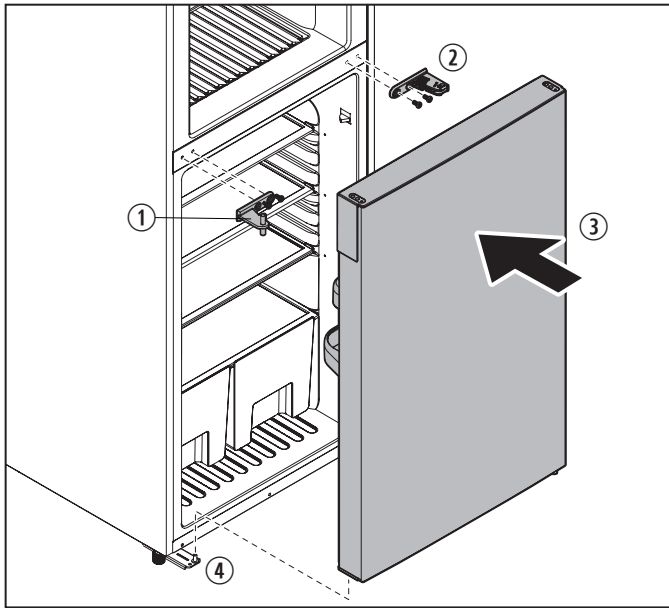

15 Reinstalling the Fresh Food Door, Lock, and Middle Hinge

- ① Middle Hinge Bracket ③ Fresh Food Door
- ② Lock and Lock Screws ④ Pin on Lower Hinge Bracket

1. Lower the fresh food door into position by aligning the hole from the door stop bushing onto the pin on the lower hinge bracket.

i The door's magnetic seal should hold the door in place to install the middle hinge bracket.

2. Align the middle hinge bracket at the edge of the fresh food door, above the lower hinge bracket.
3. Reinstall the middle hinge bracket, but do not fully tighten the screws.
4. Align the lock assembly on the other edge of the fresh food door, above the new handle location.
5. Reinstall the lock assembly, but do not fully tighten the screws.
6. Ensure the door aligns horizontally and vertically, swings freely, and seals properly on all sides.
7. Tighten all middle hinge and lock assembly screws.

8. Lower the freezer door into position by aligning the hole from the door stop bushing onto the middle hinge bracket pin.

i The door's magnetic seal should hold the door in place to install the upper hinge bracket.

6.9 Reinstalling the Upper Hinge

This section describes reinstalling the freezer door and upper hinge bracket.

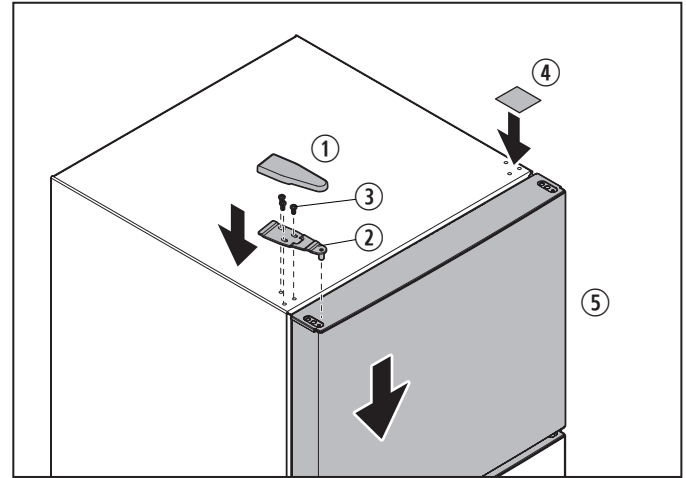

16 Reinstalling the Freezer Door and Upper Hinge

- ① Upper Hinge Cover ④ Plastic Screw Cover
- ② Upper Hinge Bracket ⑤ Freezer Door
- ③ Hinge Screws

1. Align the new upper hinge bracket at the edge of the freezer door, above the middle hinge bracket.
2. Install the new upper hinge bracket, using the three hinge screws, but do not fully tighten.
3. Ensure the door aligns horizontally and vertically, swings freely, and seals properly on all sides.
4. Fully tighten the hinge screws on the upper hinge bracket and snap the upper hinge cover in place.
5. Reinstall the plastic screw cover on the top where the old upper hinge was removed.

i If necessary, reconnect the wiring, plug in the power cord, or turn the breaker on.

6. Return the refrigerator to the enclosure as described in "Securing the Refrigerator" on page 6.
7. Level the refrigerator as described in "Positioning the Refrigerator" on page 6.

7 Operation

⚠ WARNING: ELECTRICAL SHOCK, FIRE, AND/OR EXPLOSION HAZARD. Failure to obey the following warnings could result in death or serious injury:

- This refrigerator **must** be properly installed and located in accordance with the instructions outlined in "Installation" on page 5 before it is used.
- Do **not** allow persons (including children) with reduced physical, sensory, or mental capabilities to operate this refrigerator unless they have been given supervision or instruction concerning use of the appliance by a person responsible for their safety.
- Do **not** store gasoline or other flammable vapors and liquids in this refrigerator.
- Do **not** store explosive substances, such as aerosol cans with a flammable propellant, in this refrigerator.

⚠ CAUTION: BURN HAZARD.

Do **not** touch the interior of the chiller compartment with wet hands. Failure to obey this caution could result in minor or moderate injury.

This section provides considerations regarding the operation of the refrigerator and describes how to operate the control panel.

7.1 Storing Refrigerated Goods

For optimal use of the refrigerator compartment, observe the following instructions:

- Never put hot liquids or food in the refrigerator.
- The total amount of goods placed into the refrigerator compartment should not exceed its storage volume.
- Cover or wrap food prior to storage.
- Arrange food so that air can circulate freely inside the compartment.

7.2 Using the Control Panel

This section describes how to use the control panel to set the desired cooling temperature.

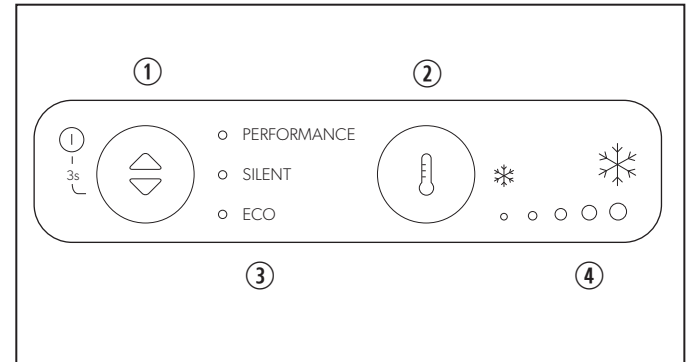

17 Understanding the Control Panel

- | | |
|-----------------------------|-------------------------|
| ① Mode Selection Button | ③ Mode Indicator |
| ② Temperature Adjust Button | ④ Temperature Indicator |

7.2.1 Turning on the Refrigerator

This section describes how to turn the refrigerator on.

1. Press and hold the mode selection button for three seconds to turn on the refrigerator.
2. Ensure that the refrigerator is cooled completely before adding food (24 hours is recommended).
3. Set the refrigerator mode by pressing the mode selection button to select from the following choices:
 - **Performance Mode:** The refrigerator works in AUTO status with five available temperature levels.
 - **Silent Mode:** The compressor works at a constant speed while the outer fan works at low speed. The temperature level is limited to level three and below.
 - **ECO Mode:** The refrigerator works in AUTO status, but the temperature is limited to level one.

7.2.2 Changing the Refrigerator Temperature

To adjust the refrigerator temperature, press and release the temperature adjust button until the temperature indicator light displays at the desired level. The small snowflake is level one and the large snowflake is level five.

7.3 Adjusting the Shelves

This section describes how to remove and install the refrigerator shelves.

7.3.1 Removing a Shelf

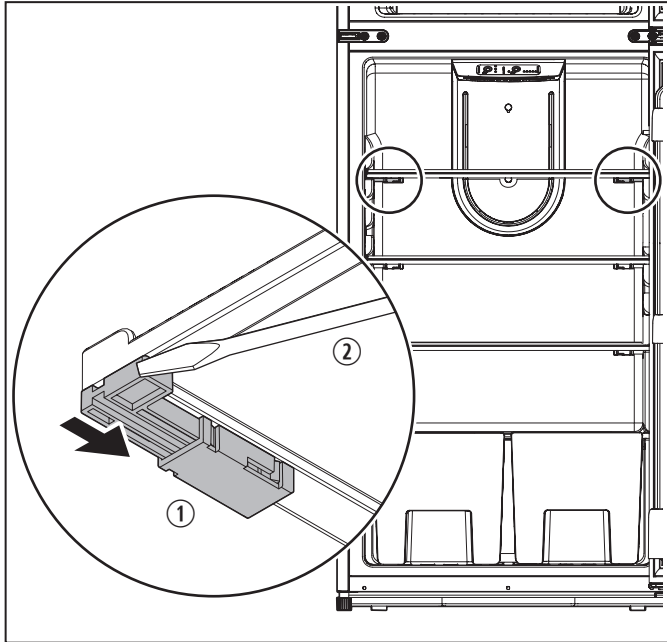

18 Removing a Refrigerator Shelf

① Shelf Lock

② Screwdriver

1. Disengage both shelf locks underneath the shelf:
 - a. Insert the tip of a flathead screwdriver into the slot between the left shelf lock and the wall liner.

NOTICE: Do **not** rest the screwdriver against the liner for leverage, or force the screwdriver against the liner, as damage to the liner may occur.

- b. Gently rotate the screwdriver to slide the lock away from the wall liner.
 - c. Repeat steps a and b for the right shelf lock.
2. Pull on the front edge to slide the shelf out.

7.3.2 Installing the Shelf

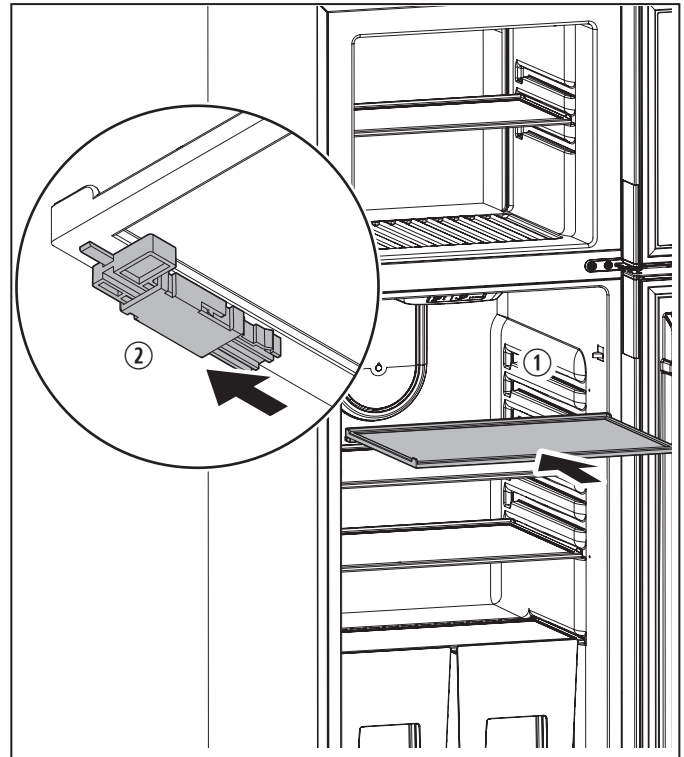

19 Installing a Refrigerator Shelf

① Groove in Wall Liner

② Shelf Lock

1. Be sure both shelf locks are disengaged.
2. Align the shelf with the grooves in the wall liner, and slide the shelf into the grooves.
3. To engage the left lock, push the end of the left lock toward the left refrigerator wall until it is flush with the end of the shelf bracket and against the wall liner.
4. Repeat step 3 for the right lock.

8 Care and Maintenance

⚠ WARNING: ELECTRICAL SHOCK, FIRE, AND/OR EXPLOSION HAZARD. Failure to obey the following warnings could result in death or serious injury:

- Always disconnect the refrigerator from power before cleaning and/or servicing.
- Maintenance not included in this Care and Maintenance section **must** be done by a qualified service person only.

⚠ WARNING: HEALTH HAZARD.

Do **not** use toxic or hazardous chemicals to accelerate the defrosting process. Failure to obey this warning could result in death or serious injury.

NOTICE: Do **not** use abrasive cleaning agents or hard objects during cleaning, and do **not** allow water to drip into the seals, as this can damage the refrigerator.

NOTICE: Never use mechanical tools to remove ice or to loosen objects stuck to the interior of the refrigerator. The only exceptions are devices that are approved for this purpose by the manufacturer.

NOTICE: The maintenance and cleaning instructions provided in this section should be performed once a year, or as needed depending on the use of the appliance. Failure to properly maintain the appliance might void the warranty and could result in unsafe operation. Preventive maintenance is **not** covered under the warranty.

8.1 Defrosting the Refrigerator

The refrigerator has an auto-defrost feature that will automatically start a heating device to assist defrosting after a certain period of run time.

8.2 Cleaning the Refrigerator

NOTICE: The exterior surface should only be cleaned with soap and water. Failure to obey this notice could result in damage to the refrigerator's finish.

Complete these steps to properly clean the refrigerator:

1. Clean the interior regularly, and as soon as it becomes dirty, using a damp cloth. Wipe dry.
2. Clean dust and debris from the condenser fan regularly, and ensure that the fan moves freely without obstruction.

8.3 Storing the Refrigerator

If you do not intend to use the refrigerator for an extended period of time, complete the following steps:

1. Empty the contents of the refrigerator compartment.
2. Clean the refrigerator, if needed, as described in "Cleaning the Refrigerator" on page 15.

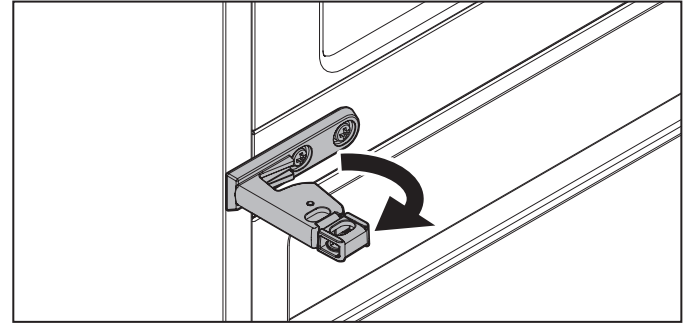

20 Swinging out the Airing Feature

3. To prevent mold, mildew, or unpleasant odors from developing, leave the door slightly ajar. Use the airing feature to prevent the door from closing:
 - a. Open both the freezer and fresh food door to access the lock.
 - b. Swing the airing feature out from the lock.
 - c. Close the doors until they gently rest against the airing feature on the door lock.

9 Troubleshooting

⚠ WARNING: ELECTRICAL SHOCK, FIRE, AND/OR EXPLOSION HAZARD. Failure to obey the following warnings could result in death or serious injury:

- Always disconnect the refrigerator from power before cleaning and/or servicing.
- Maintenance not included in this Troubleshooting section **must** be done by a qualified service person only.

The following table lists some of the possible issues that might be encountered when the refrigerator is in use, the possible causes of these issues, and the recommended actions that should be taken to remedy the issues.

Problem	Possible Cause	Suggested Remedy
The refrigerator will not operate.	The power supply cord is disconnected.	Ensure that the refrigerator is connected and power is supplied.
	The refrigerator is powered off.	Hold the mode button for three seconds to turn on the refrigerator.
	A household fuse or circuit breaker has tripped.	Ensure that there is power supplied to the refrigerator.
Food in the refrigerator compartment is freezing.	The internal temperature is set too cold.	Adjust the temperature to a warmer setting.
The internal temperature in the refrigerator compartment is not cool enough.	The air vents in the fresh food compartment are blocked; this prevents the movement of cold air.	Ensure that the vents are clear and that there are proper clearances around the refrigerator.
	The refrigerator is placed too close to heat sources, or poor ventilation exists.	
	The door is opened too often or not closed properly.	Limit the amount of time that the door is opened during operation.
	A large amount of food has just been added to the refrigerator compartment.	Cool food before inserting it into the refrigerator. Adding warm food to the refrigerator delays cooling.
	The temperature setting is adjusted too warm.	Set the thermostat to a cooler setting.
The refrigerator seems to make unusual noise.	The refrigerator is not leveled on the floor.	Ensure that the refrigerator is properly leveled. Refer to "Positioning the Refrigerator" on page 6.
	The body of the refrigerator touches a wall.	Ensure that there are proper clearances around the refrigerator. Refer to "Positioning the Refrigerator" on page 6.
There is interior moisture build-up.	The door is opened too often or not closed properly.	Limit the amount of time that the door is opened during operation and ensure that the door is properly closed after opening.
	The room is humid.	Install the refrigerator in an area with less humidity, if possible.
	The food is not packaged correctly.	Follow the recommended packaging instructions. Refer to "Operation" on page 13 for details.
The door will not close completely.	Food packages are keeping the door from closing properly.	Ensure that contents in the cooling compartment do not obstruct the door.
	The shelves are out of position.	Ensure that the shelves are in their correct positions.
	The gaskets are dirty.	Clean the gaskets with a damp cloth.
	The refrigerator is not level.	Ensure that the refrigerator is properly leveled. Refer to "Positioning the Refrigerator" on page 6.

10 Disposal



Place the packaging material in the appropriate recycling waste bins, whenever possible. Consult a local recycling center or specialist dealer for details about how to dispose of the product in accordance with all applicable national and local regulations.

LIMITED ONE-YEAR WARRANTY

LIMITED ONE-YEAR WARRANTY AVAILABLE AT
WWW.DOMETIC.COM/WARRANTY.

IF YOU HAVE QUESTIONS, OR TO OBTAIN A COPY
OF THE LIMITED WARRANTY FREE OF CHARGE,
CONTACT:

DOMETIC CORPORATION
CUSTOMER SUPPORT CENTER
1120 NORTH MAIN STREET
ELKHART, INDIANA, USA 46514
1-800-544-4881 OPT 1

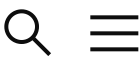

New



Feedback

Dometic MoBar 550 S

Outdoor mobile bar, rotomolded basket, dual zone refrigerator, stainless-steel



The Dometic MoBar 550 is the ultimate mobile bar for your outdoor living space. Professionally graded with a timeless state-of-the-art patented design, it doesn't compromise style for functionality or convenience, allowing hosts and their guests to socialize outdoors without ever missing a moment.

[Visit support page + FAQ](#)

item nr. 9600037329 (MOBAR550-D65-A)

Feedback

SERVE AND ENTERTAIN GUESTS IN STYLE

Hosting a get-together with friends and family is one of life's great pleasures, but it's not without its challenges – especially in an outdoor setting. With its versatile design features, stylish presentation options and superb cooling performance, the Dometic MoBar 550 is a focal point for bringing people together, while ensuring guests are looked after. Combine being a great host with enjoying unforgettable shared experiences.





SUPERIOR ICE RETENTION

Rotomolded presentation basket will keep bottles ice-cold.

Feedback



Feedback

MODULAR DRY STORAGE

Large dry storage area, to keep everything you need within easy reach.



Feedback

PROFESSIONAL ACCESSORIES

Developed in collaboration with professional bartenders.



Feedback

MOOD ENHANCING LIGHTING

Keeps drinks visible, accessible, and looking enticing.

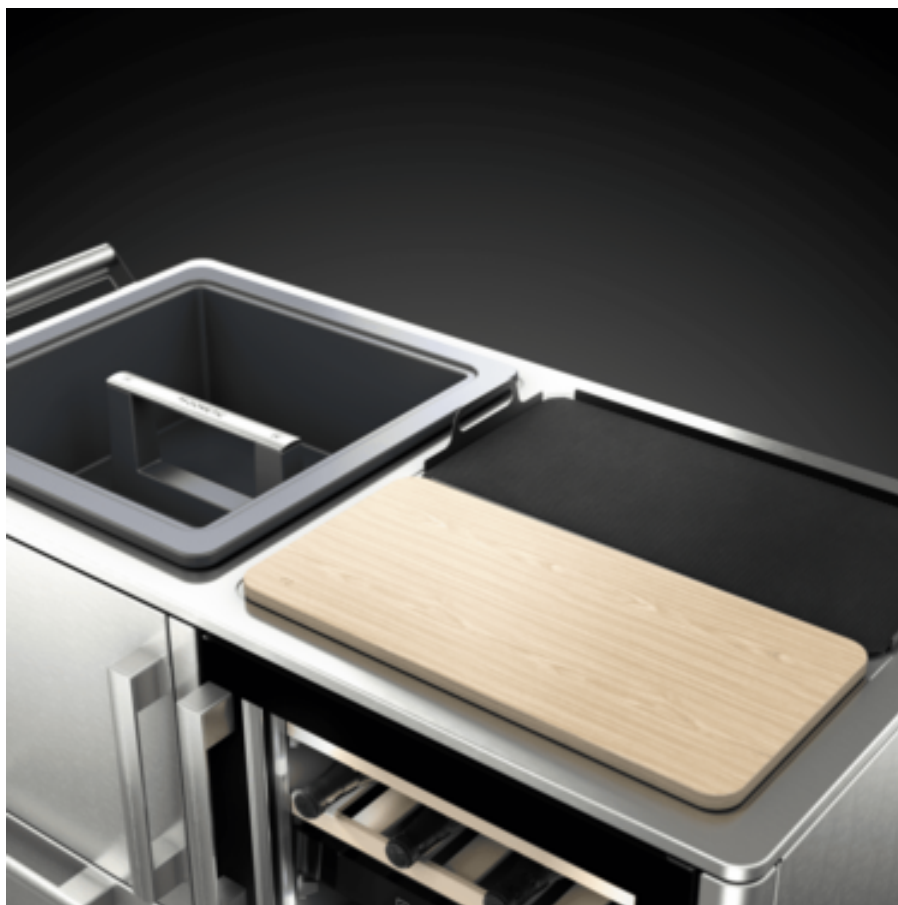

Feedback

SPACIOUS PRESENTATION AREA

Prepare, mix and present like a professional.



THE MOBAR IN MOTION

Combine being a great host with enjoying unforgettable shared experiences.



DOMETIC MOBAR 550 S

INSPIRED BY PROFESSIONALS, DESIGNED FOR OUTDOOR ENTERTAINERS

Entertain guests in style with the Dometic MoBar 550 – whatever the occasion. With its spacious presentation and preparation area, robust stainless-steel design, heavy-duty wheels and ergonomic handles the MOBAR can be placed at the heart of any outdoor event. Drawing on Dometic's long history of cooling innovation, the MoBar 550 delivers high-performance outdoor drink cooling. Adjustable temperature settings and dual-zone cooling provide versatility, while the generous storage capacity of its main compartment can hold up to 39 bottles or 155 cans. Up to additionally 22 bottles or 32 cans can be stored in an insulated rotomolded ice basket, so you need never worry about running out of chilled drinks.

SPECIFICATIONS

GENERAL

SKU number 9600037329

Model MoBar550S

Model on label MOBAR550

Scope of delivery MoBar550S, Serving tray, Cutting board, Speed rail, Ice and garnish container, Towel bar handle

Product Description Outdoor mobile bar, rotomolded basket, dual zone refrigerator, stainless-steel

Refrigeration technology Compressor

DIMENSIONS

Dimensions product depth 624 mm

Dimensions product height 980 mm

Dimensions product width 1249 mm

Net weight 113.40 kg

ELECTRICAL

Input voltage (AC) 120 V

Rated input power (AC) 80±10 W

Input frequency 60 Hz

PERFORMANCE

Refrigerant, type R600a

Refrigerant amount 28 g

Noise (EN60704-1 & 60704-2-14) 41.00 dB(A)

Noise Class EU20192016 C

Climate class (EN 62552) ST

ADDITIONAL

Color StainlessSteel & Black

Hinge type Right hinged

Interior light Yes, LED

Certificates ETL

Winecellar capacity 38 Bordeaux bottles, 75cl

LOGISTICS

EAN-13 713814334383

Dimensions parcel depth 690 mm

Dimensions parcel height 1215 mm

Dimensions parcel width 1260 mm

Parcel weight 144.40 kg

Feedback

DOCUMENTS

Download



OPERATING MANUAL

Dometic MoBar 300S, MoBar 550S - Operating Manual AMERICAS(en-es-fr)



SHORT OPERATING MANUAL

Dometic MoBar 300S, MoBar 550S - Short Operating Manual AMERICAS(en-fr-es)